

# **General Information Items for the Board of Education**





## KENAI PENINSULA BOROUGH SCHOOL DISTRICT

148 North Binkley Street Soldotna, Alaska 99669-7520

Phone (907) 714-8888 Fax (907) 262-9132

[www.kpbsd.k12.ak.us](http://www.kpbsd.k12.ak.us)

### SCHOOL BOARD COMMUNICATION

<b>Title:</b>	2015-16 Administrator Changes in Assignments		
<b>Date:</b>	May 4, 2015	<b>Item Number:</b>	
<b>Administrator:</b>	Joann Riener, Director, Human Resources Dave Jones, Assistant Superintendent		
<b>Attachments:</b>	Résumé		

☐ Action Needed    ☐ For Discussion    ☒ Information    ☐ Other: \_\_\_\_\_

### BACKGROUND INFORMATION

Name	From	To
John Pothast	Principal, Redoubt Elementary School	Director of Secondary Education & Student Activities
Timothy Whip	Principal/Teacher, Razdolna School	Regional Administrator, Razdolna School and Kachemak Selo School

### ADMINISTRATIVE RECOMMENDATION

# **John Gary Pothast**

## **Administrative Experience**

### **Principal, Redoubt Elementary School, 2005-Present**

- Instructional leader for school of 400 students, 26 teachers and twenty support staff
- Responsible for all aspects of an elementary school including budget, academic and co-curricular programs and maintaining positive school and community climate. Providing leadership, direction and support to school in the areas of curriculum, instruction, assessment.
- Highlights include implementation of School-Wide PBIS, effectively implementing standards-based reporting system and development of effective Professional Learning Communities.

### **Principal, Skyview High School, 1999-2005**

- Instructional leader for school of 600 students, forty teachers and twenty support staff
- Responsible for all aspects of a large, comprehensive high school, including budget, academic and co-curricular programs, and maintaining positive school and community climate. Providing leadership, direction and support to school in the areas of curriculum, instruction, assessment.
- Highlights include development and implementation of Aspirations Advocates Mentor Program, development of a ninth-grade team and development of After-The-Bell tutoring program.

## **Teaching Experience**

### **English teacher, Cibola High School, 1993-1999 –Yuma, Arizona**

- Taught eleventh grade English (American Literature), twelfth grade English (British Literature) and Advanced Placement English, Academic Decathlon, Speech/Debate.
- Developed curriculum for, and taught College Preparatory Literature class
- Freshmen girls volleyball coach
- As department chair (1997-1999), supervised 18 teachers, performed evaluations and maintained department budget.

### **English teacher, Arizona Western College, 1994-1996--Yuma, Arizona**

- Taught English 101: Freshman Composition

### **Physical education teacher, St. John's School, 1992-1993-- Tumon Bay, Guam**

- Taught physical education, grades 4-12, seventh grade word processing and eighth grade critical reading and writing course.
- Head Coaching duties: Varsity boys and girls volleyball, tennis and golf. Junior High Quiz Bowl

### **English teacher, Cibola High School, 1989-1992--Yuma, Arizona**

- Taught tenth grade honors English, eleventh grade English (American Literature), twelfth grade English (British Literature).
- Developed curriculum for, and taught, Advanced Placement English, Academic Decathlon, and Speech/Debate. Head coach for Speech/Debate and Academic Decathlon.

## **Professional Involvement**

- National Association of Elementary School Principals (NAESP), 2005-present
  - NAESP & NASSP Joint Teacher Evaluation Committee, 2013-2014
  - Federal Relations Conference/National Leaders Conference participant, 2011-present
- Alaska Association of Elementary School Principals, 2005-present
  - Positions held include President, President-Elect and Region Member At-Large
- Alaska Council of School Administrators Board of Directors, 2003-present
  - Positions held include President and Board member
- National Association of Secondary School Administrators (NASSP), 1999-2005
- Alaska Association of Secondary School Administrators, 1999-2005
  - Positions held include President-Elect and Region Director
- Kenai Peninsula Administrator's Association 1999-Present
  - Positions held include President, Vice President/Secretary and Treasurer

## **Awards and Honors**

- State of Alaska Principal of the Year Award (NASSP), 2004
- Service Award, Soldotna Rotary Club, 2003
- Alaska's Region III Principal of the Year, 2003
- State of Alaska Technology Leader of the Year Award, October, 2002

## **Community Involvement**

- Tsalteshi Trails Association President, 2014-present
- Soldotna Rotary Club Member, 2000-present
  - Positions held include Youth Activities Chair, Youth Exchange Counselor, Club President, and Interact Club Sponsor (Rotary Club for students)
- Church Council President, 2006-present

## **Related Experience**

- Presenter at a variety of conferences at the national, state and local level, 2000-present
- Teacher Evaluation/Effective Instruction Committee, Kenai Peninsula School District, 2008-present
- Team-taught "The Principalship" class, University of Maine. July, 2001
- Language Arts Curriculum Adoption Committee, KPBSD, 2001-2002

## **Education**

- **M.ED.** Educational Leadership, Northern Arizona University;
- **B.A.A.** Secondary Education: English and Communications, University of Minnesota-Duluth

**KENAI PENINSULA BOROUGH SCHOOL DISTRICT**  
**Student Growth Maps Meeting Agenda**  
**Challenger Learning Center**  
**Wednesday, April 29, 2015**



*KPBSD – Working to develop productive, responsible citizens who are prepared to be successful in a dynamic world.*

## **AGENDA**

<b>Time</b>	<b>Topic</b>
8:00-8:30 AM	Coffee and Conversation
8:30-8:45 AM	Opening Remarks from Superintendent
8:45-9:00 AM	Celebrations
9:00-9:15 AM	What's Expected? What gets turned in, when, and to whom?
9:15-10:00 AM	Content-Alikes: Sharing new discoveries and wonderings
10:00-10:15 AM	Break
10:15-11:00 AM	Goal Setting Methods: What works best with various data?
11:00-11:50 AM	Protocol for SGM Improvement: Experience It!
11:50-12:00 PM	Feedback on protocol via Padlet
12:00-12:45 PM	Lunch
12:45 – 1:15 PM	Update on Regulations: What's New?
1:15-1:45 PM	Addressing Unanswered Questions
1:45-2:15 PM	Rediker Preview: How might we make this easier?
2:15-2:30 PM	Break
2:30-3:00 PM	End of year/End of Pilot Year 1 Procedures
3:00-4:00 PM	Planning for 15-16: District and site level needs
4:00 PM	Adjourn



## KENAI PENINSULA BOROUGH SCHOOL DISTRICT

148 North Binkley Street Soldotna, Alaska 99669-7520

Phone (907) 714-8888 Fax (907) 262-9132

[www.kpbsd.k12.ak.us](http://www.kpbsd.k12.ak.us)

### SCHOOL BOARD COMMUNICATION

**Title:** Borough Assembly Action

**Date:** April 14, 2015

**Item Number:**

**Administrator:** Dave Jones, Assistant Superintendent *Dave Jones*

**Attachments:** School Related Items on the April 21, 2015 Borough Assembly Agenda

☐ **Action  
Needed**

☐ **For  
Discussion**

☒ **Information**

☐ **Other:**

### BACKGROUND INFORMATION

Attached is information pertaining to the School District which will be presented at the April 21, 2015 Borough Assembly meeting:

- Authorization to award contract for door replacement project 2015
- Ordinance 2014-19-49, appropriating \$250,000 for professional design services associated with the Susan B. English School shop restoration project
- Ordinance 2014-19-53, appropriating \$165,185.50 in the Borough's School Revenue Capital Project funds for improvements to school facilities

### ADMINISTRATIVE RECOMMENDATION

For your information.



## KENAI PENINSULA BOROUGH

Maintenance Department  
47140 E. Poppy Ln., Soldotna, Alaska 99669  
907-262-4011 • Fax 907-262-5882  
[www.borough.kenai.ak.us/maintenance](http://www.borough.kenai.ak.us/maintenance)



MIKE NAVARRE  
BOROUGH MAYOR

### MEMORANDUM

**TO:** Mike Navarre, Mayor

**THRU:** Mark Fowler, Purchasing & Contracting Director *[Signature]*

**FROM:** Scott Griebel, Maintenance Director *[Signature]*

**DATE:** April 6, 2015

**SUBJECT:** Authorization to Award Contract for Door Replacement Project 2015

The Purchasing and Contracting Office formally solicited and received bids for the "Door Replacement project 2015" project. Bid packets were released on March 17, 2015 and the Invitation to Bid was advertised in the Peninsula Clarion on March 17, 2015.

The project consists of providing all labor and material for the replacement of four (4) exterior door assemblies and six (6) interior door assemblies at Soldotna High School, Soldotna Prep and Skyview Middle School.

On the due date of April 1, 2015, four (4) bids were received and reviewed to ensure that all the specifications and delivery schedules were met. The low bid of \$68,970.00 was submitted by Polar North Construction, 37770 Connor Rd., Soldotna, AK 99669.

Your approval for this bid award is hereby requested. Funding for this project is in account number 400.78050.14728.43780 and 400.78050.15728.43780.

Approved:

*[Signature: Mike Navarre]*  
Mike Navarre, Mayor

*4/7/15*  
Date

#### FINANCE DEPARTMENT FUNDS VERIFIED

Acct #400.78050.14728.43780 - \$30,936.46  
Acct #400.78050.15728.43780 - \$38,033.54

BY: *pp* DATE: *4/6/15*

*C. Chapp*

**KENAI PENINSULA BOROUGH  
PURCHASING & CONTRACTING**

**BID TAB FOR: ITB 15-028 Door Replacement Project 2015**

CONTRACTOR	LOCATION	SOLDOTNA HIGH	SOLDOTNA PREP	SKYVIEW MIDDLE	TOTAL EXTENDED BID
Diversified Construction	Eagle River	\$ 15,120.00	\$ 18,500.00	\$ 60,763.00	\$94,383.00
Blomfield Construction	Anchorage	\$ 12,739.00	\$ 44,505.00	\$ 13,339.00	\$70,583.00
Holden Company	Soldotna	\$ 15,958.00	\$ 17,683.00	\$ 65,807.00	\$99,448.00
Polar North Construction	Soldotna	\$ 10,729.00	\$ 12,719.00	\$ 45,522.00	\$68,970.00

**Estimate \$65,000.00**

**DUE DATE: April 1, 2015 @ 2:00 PM**

**KPB OFFICIAL:**

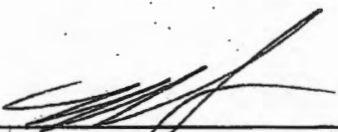
  
Mark Fowler, Purchasing & Contracting Director





## KENAI PENINSULA BOROUGH

144 North Binkley Street • Soldotna, Alaska 99669-7520

Toll-free within the Borough: 1-800-478-4441

PHONE: (907) 262-4441 • FAX: (907) 262-1892

www.kpb.us

MIKE NAVARRE  
BOROUGH MAYOR

### MEMORANDUM

**TO:** Dale Bagley, Assembly President  
Members, Kenai Peninsula Borough Assembly

**THRU:** Mike Navarre, Mayor *MD*

**FROM:** Tim Bryner, Risk Manager *TB*  
Craig Chapman, Director of Finance *C Chapman*

**DATE:** March 26, 2015

**SUBJECT:** Ordinance 2014-19-49, An Ordinance Appropriating \$250,000 for Professional Design Services Associated with the Susan B. English School Shop Restoration Project

A fire occurred at the Susan B. English School shop in Seldovia on November 24, 2014 for which substantial repairs are needed. A request for proposals has been issued for professional design services for the needed restoration and the borough's insurance should cover the majority of the cost of the needed restoration.

This ordinance appropriates \$250,000 from the estimated insurance proceeds that will be received for the Susan B. English School shop fire damages which will provide the initial funding necessary to award the design.

After the design is completed, a second ordinance will be submitted to the assembly for the funding necessary for the needed restoration.

FINANCE DEPARTMENT ACCOUNT FUNDS VERIFIED	
Acct. No.	<u>400.74010.D056m.49999</u>
Amount	<u>N/A</u>
By: <u>pp</u>	Date: <u>3/25/15</u>

Introduced by:

Mayor

Date:

04/07/15

Hearing:

04/21/15

Action:

Vote:

**KENAI PENINSULA BOROUGH  
ORDINANCE 2014-19-49**

**AN ORDINANCE APPROPRIATING \$250,000 FOR PROFESSIONAL DESIGN  
SERVICES ASSOCIATED WITH THE SUSAN B. ENGLISH SCHOOL SHOP  
RESTORATION PROJECT**

**WHEREAS,** a fire occurred at the Susan B. English school shop in Seldovia on November 24, 2014 resulting in substantial damage; and

**WHEREAS,** the majority of the restoration cost will be covered by insurance proceeds; and

**WHEREAS,** a request for proposals (RFP) for professional design services associated with the shop restoration has been issued; and

**WHEREAS,** funding is needed in order to award the cost of the professional design service contract;

**NOW, THEREFORE, BE IT ORDAINED BY THE ASSEMBLY OF THE KENAI  
PENINSULA BOROUGH:**

**SECTION 1.** That the mayor is authorized to receive property insurance proceeds from the borough's insurers for the Susan B. English school shop fire damages.

**SECTION 2.** That estimated insurance proceeds in the amount of \$250,000 are appropriated to account 400.74010.D056M.49999.

**SECTION 2.** That this ordinance takes effect immediately upon its enactment.

**ENACTED BY THE ASSEMBLY OF THE KENAI PENINSULA BOROUGH THIS \*  
DAY OF \* 2015.**

\_\_\_\_\_  
Dale Bagley, Assembly President

ATTEST:

\_\_\_\_\_  
Johni Blankenship, MMC, Borough Clerk

**Yes:**

**No:**

**Absent:**



## KENAI PENINSULA BOROUGH

144 North Binkley Street • Soldotna, Alaska 99669-7520

Toll-free within the Borough: 1-800-478-4441

PHONE: (907) 262-4441 • FAX: (907) 262-1892

www.kpb.us

MIKE NAVARRE  
BOROUGH MAYOR

### MEMORANDUM

**TO:** Dale Bagley, Assembly President  
Members, Kenai Peninsula Borough Assembly

**THRU:** Mike Navarre, Mayor *mn*

**FROM:** Craig Chapman, Finance Director *C Chapman*  
Kevin Lyon, Capital Projects Director *KL*

**DATE:** April 9, 2015

**SUBJECT:** Ordinance 2014-19-~~53~~, An Ordinance Appropriating \$165,185.50 in the Borough's School Revenue Capital Project Funds for Improvements to School Facilities

The Kenai Peninsula Borough School District (School District) has funds set aside for improving school facilities. The School District and the borough's maintenance and capital projects departments have worked together to develop a plan to expand parking at Aurora Borealis Charter School to address space and safety concerns. The School District is requesting the borough move forward with this project and has committed to provide the \$165,185.50 in funding needed for this project.

FINANCE DEPARTMENT  
ACCOUNT / FUNDS VERIFIED

Acct. No. 400.73010.15PRK.49999

Amount N/A

By: pp Date: 4/8/15



## KENAI PENINSULA BOROUGH SCHOOL DISTRICT

### Assistant Superintendent

Dave Jones

148 North Binkley Street Soldotna, Alaska 99669-7553

Phone (907) 714-8888 Fax (907) 262-5867

Email: davejones@kpbsd.k12.ak.us

April 7, 2015

Craig Chapman, Director of Finance  
Kenai Peninsula Borough  
144 N. Binkley  
Soldotna, AK 99669

Re: Capital Project – Aurora Borealis Parking Expansion

Dear Craig,

School District and Borough Maintenance employees have worked together this year to develop a plan to expand parking at Aurora Borealis Charter School to address space and safety concerns. The Charter School Committee has approved the project and the Capital Projects Department has provided a Statement of Probable Cost including a Project Cost Estimate of \$165,185.50.

Please consider this letter the district's request to proceed with the project and our commitment to fund it.

We appreciate the borough's assistance with moving this project forward for the summer 2015 construction season.

Sincerely,

A handwritten signature in cursive script, appearing to read "Dave Jones".

Dave Jones

cc: Kevin Lyons, KPB  
Julie Cisco, KPBSD



Introduced by: Mayor  
Date: 04/21/15  
Hearing: 05/05/15  
Action:  
Vote:

**KENAI PENINSULA BOROUGH  
ORDINANCE 2014-19-53**

**AN ORDINANCE APPROPRIATING \$165,185.50 IN THE BOROUGH'S SCHOOL  
REVENUE CAPITAL PROJECT FUNDS FOR IMPROVEMENTS TO SCHOOL  
FACILITIES**

**WHEREAS,** the Kenai Peninsula Borough School District has funds set aside for improving school facilities; and

**WHEREAS,** the school district and the borough's maintenance and capital projects departments have worked together to develop a plan to expand parking at Aurora Borealis Charter School to address space and safety concerns; and

**WHEREAS,** as the schools are owned by the borough, it is suitable for the borough to appropriate the funds necessary for these projects; and

**WHEREAS,** the estimated cost of the project is \$165,185.50 and the school district has committed to providing the funding necessary to complete the project;

**NOW, THEREFORE, BE IT ORDAINED BY THE ASSEMBLY OF THE KENAI  
PENINSULA BOROUGH:**

**SECTION 1.** That the administration is authorized to accept \$165,185.50 from the Kenai Peninsula Borough School District for parking improvements to Aurora Borealis Charter School to address space and safety concerns.

**SECTION 2.** That \$165,185.50 is appropriated in the School Revenue Capital Projects Fund to account 400.73010.15PRK.49999 for Aurora Borealis Charter School parking improvements.

**SECTION 3.** That this ordinance takes effect immediately upon its enactment.

**ENACTED BY THE ASSEMBLY OF THE KENAI PENINSULA BOROUGH THIS \*  
DAY OF \* 2015.**

\_\_\_\_\_  
Dale Bagley, Assembly President

ATTEST:

\_\_\_\_\_  
Johni Blankenship, MMC, Borough Clerk

Yes:

No:

Absent:



## KENAI PENINSULA BOROUGH SCHOOL DISTRICT

148 North Binkley Street Soldotna, Alaska 99669-7520

Phone (907) 714-8888 Fax (907) 262-9132

[www.kpbsd.k12.ak.us](http://www.kpbsd.k12.ak.us)

### SCHOOL BOARD COMMUNICATION

<b>Title:</b>	Borough Assembly Action		
<b>Date:</b>	April 28, 2015	<b>Item Number:</b>	
<b>Administrator:</b>	Dave Jones, Assistant Superintendent <i>Dave Jones</i>		
<b>Attachments:</b>	School Related Items on the May 5, 2015 Borough Assembly Agenda		

☐ **Action  
Needed**

☐ **For  
Discussion**

☒ **Information**

☐ **Other:**

### BACKGROUND INFORMATION

Attached is information pertaining to the School District which will be presented at the May 5, 2015 Borough Assembly meeting:

- Ordinance 2014-19-49, appropriating \$250,000 for professional design services associated with the Susan B. English School shop restoration project
- Ordinance 2014-19-53, appropriating \$165,185.50 in the Borough's School Revenue Capital Project Funds for improvements to school facilities; to expand parking at Aurora Borealis Charter School

### ADMINISTRATIVE RECOMMENDATION

For your information.





## KENAI PENINSULA BOROUGH

144 North Binkley Street • Soldotna, Alaska 99669-7520

Toll-free within the Borough: 1-800-478-4441

PHONE: (907) 262-4441 • FAX: (907) 262-1892

www.kpb.us

MIKE NAVARRE  
BOROUGH MAYOR

### MEMORANDUM

**TO:** Dale Bagley, Assembly President  
Members, Kenai Peninsula Borough Assembly

**THRU:** Mike Navarre, Mayor *MD*

**FROM:** Tim Bryner, Risk Manager *TB*  
Craig Chapman, Director of Finance *C Chapman*

**DATE:** March 26, 2015

**SUBJECT:** Ordinance 2014-19-49, An Ordinance Appropriating \$250,000 for Professional Design Services Associated with the Susan B. English School Shop Restoration Project

A fire occurred at the Susan B. English School shop in Seldovia on November 24, 2014 for which substantial repairs are needed. A request for proposals has been issued for professional design services for the needed restoration and the borough's insurance should cover the majority of the cost of the needed restoration.

This ordinance appropriates \$250,000 from the estimated insurance proceeds that will be received for the Susan B. English School shop fire damages which will provide the initial funding necessary to award the design.

After the design is completed, a second ordinance will be submitted to the assembly for the funding necessary for the needed restoration.

FINANCE DEPARTMENT ACCOUNT FUNDS VERIFIED	
Acct. No.	<u>400.74010.D056M.49999</u>
Amount	<u>N/A</u>
By: <u>pp</u>	Date: <u>3/25/15</u>

Introduced by: Mayor  
Date: 04/07/15  
Hearing: 04/21/15  
Action: Enacted  
Vote: 9 Yes, 0 No, 0 Absent

**KENAI PENINSULA BOROUGH  
ORDINANCE 2014-19-49**

**AN ORDINANCE APPROPRIATING \$250,000 FOR PROFESSIONAL DESIGN  
SERVICES ASSOCIATED WITH THE SUSAN B. ENGLISH SCHOOL SHOP  
RESTORATION PROJECT**

**WHEREAS,** a fire occurred at the Susan B. English school shop in Seldovia on November 24, 2014 resulting in substantial damage; and

**WHEREAS,** the majority of the restoration cost will be covered by insurance proceeds; and

**WHEREAS,** a request for proposals (RFP) for professional design services associated with the shop restoration has been issued; and

**WHEREAS,** funding is needed in order to award the cost of the professional design service contract;

**NOW, THEREFORE, BE IT ORDAINED BY THE ASSEMBLY OF THE KENAI PENINSULA BOROUGH:**

**SECTION 1.** That the mayor is authorized to receive property insurance proceeds from the borough's insurers for the Susan B. English school shop fire damages.

**SECTION 2.** That estimated insurance proceeds in the amount of \$250,000 are appropriated to account 400.74010.D056M.49999.

**SECTION 2.** That this ordinance takes effect immediately upon its enactment.

**ENACTED BY THE ASSEMBLY OF THE KENAI PENINSULA BOROUGH THIS 21ST DAY OF APRIL, 2015.**

*Dale Bagley*

Dale Bagley, Assembly President

ATTEST:

*John Blankenship*  
Johni Blankenship, MMC, Borough Clerk



Yes: Cooper, Haggerty, Gilman, Johnson, McClure, Ogle, Welles, Wolf, Bagley  
No: None  
Absent: None



## KENAI PENINSULA BOROUGH

144 North Binkley Street • Soldotna, Alaska 99669-7520

Toll-free within the Borough: 1-800-478-4441

PHONE: (907) 262-4441 • FAX: (907) 262-1892

www.kpb.us

MIKE NAVARRE  
BOROUGH MAYOR

### MEMORANDUM

**TO:** Dale Bagley, Assembly President  
Members, Kenai Peninsula Borough Assembly

**THRU:** Mike Navarre, Mayor *MN*

**FROM:** Craig Chapman, Finance Director *C Chapman*  
Kevin Lyon, Capital Projects Director *K Lyon*

**DATE:** April 9, 2015

**SUBJECT:** Ordinance 2014-19-53, An Ordinance Appropriating \$165,185.50 in the Borough's School Revenue Capital Project Funds for Improvements to School Facilities

The Kenai Peninsula Borough School District (School District) has funds set aside for improving school facilities. The School District and the borough's maintenance and capital projects departments have worked together to develop a plan to expand parking at Aurora Borealis Charter School to address space and safety concerns. The School District is requesting the borough move forward with this project and has committed to provide the \$165,185.50 in funding needed for this project.

FINANCE DEPARTMENT  
ACCOUNT / FUNDS VERIFIED

Acct. No. 400.73010.15PRK.49999

Amount N/A

By: pp Date: 4/8/15



Introduced by: Mayor  
Date: 04/21/15  
Hearing: 05/05/15  
Action:  
Vote:

**KENAI PENINSULA BOROUGH  
ORDINANCE 2014-19-53**

**AN ORDINANCE APPROPRIATING \$165,185.50 IN THE BOROUGH'S SCHOOL  
REVENUE CAPITAL PROJECT FUNDS FOR IMPROVEMENTS TO SCHOOL  
FACILITIES**

**WHEREAS,** the Kenai Peninsula Borough School District has funds set aside for improving school facilities; and

**WHEREAS,** the school district and the borough's maintenance and capital projects departments have worked together to develop a plan to expand parking at Aurora Borealis Charter School to address space and safety concerns; and

**WHEREAS,** as the schools are owned by the borough, it is suitable for the borough to appropriate the funds necessary for these projects; and

**WHEREAS,** the estimated cost of the project is \$165,185.50 and the school district has committed to providing the funding necessary to complete the project;

**NOW, THEREFORE, BE IT ORDAINED BY THE ASSEMBLY OF THE KENAI  
PENINSULA BOROUGH:**

**SECTION 1.** That the administration is authorized to accept \$165,185.50 from the Kenai Peninsula Borough School District for parking improvements to Aurora Borealis Charter School to address space and safety concerns.

**SECTION 2.** That \$165,185.50 is appropriated in the School Revenue Capital Projects Fund to account 400.73010.15PRK.49999 for Aurora Borealis Charter School parking improvements.

**SECTION 3.** That this ordinance takes effect immediately upon its enactment.

**ENACTED BY THE ASSEMBLY OF THE KENAI PENINSULA BOROUGH THIS \*  
DAY OF \* 2015.**

\_\_\_\_\_  
Dale Bagley, Assembly President

ATTEST:

\_\_\_\_\_  
Johni Blankenship, MMC, Borough Clerk

Yes:

No:

Absent:



## KENAI PENINSULA BOROUGH SCHOOL DISTRICT

**Assistant Superintendent**

**Dave Jones**

148 North Binkley Street Soldotna, Alaska 99669-7553

Phone (907) 714-8888 Fax (907) 262-5867

Email: [davejones@kpbsd.k12.ak.us](mailto:davejones@kpbsd.k12.ak.us)

April 7, 2015

Craig Chapman, Director of Finance  
Kenai Peninsula Borough  
144 N. Binkley  
Soldotna, AK 99669

Re: Capital Project – Aurora Borealis Parking Expansion

Dear Craig,

School District and Borough Maintenance employees have worked together this year to develop a plan to expand parking at Aurora Borealis Charter School to address space and safety concerns. The Charter School Committee has approved the project and the Capital Projects Department has provided a Statement of Probable Cost including a Project Cost Estimate of \$165,185.50.

Please consider this letter the district's request to proceed with the project and our commitment to fund it.

We appreciate the borough's assistance with moving this project forward for the summer 2015 construction season.

Sincerely,

A handwritten signature in cursive script, appearing to read "Dave Jones".

Dave Jones

cc: Kevin Lyons, KPB  
Julie Cisco, KPBSD



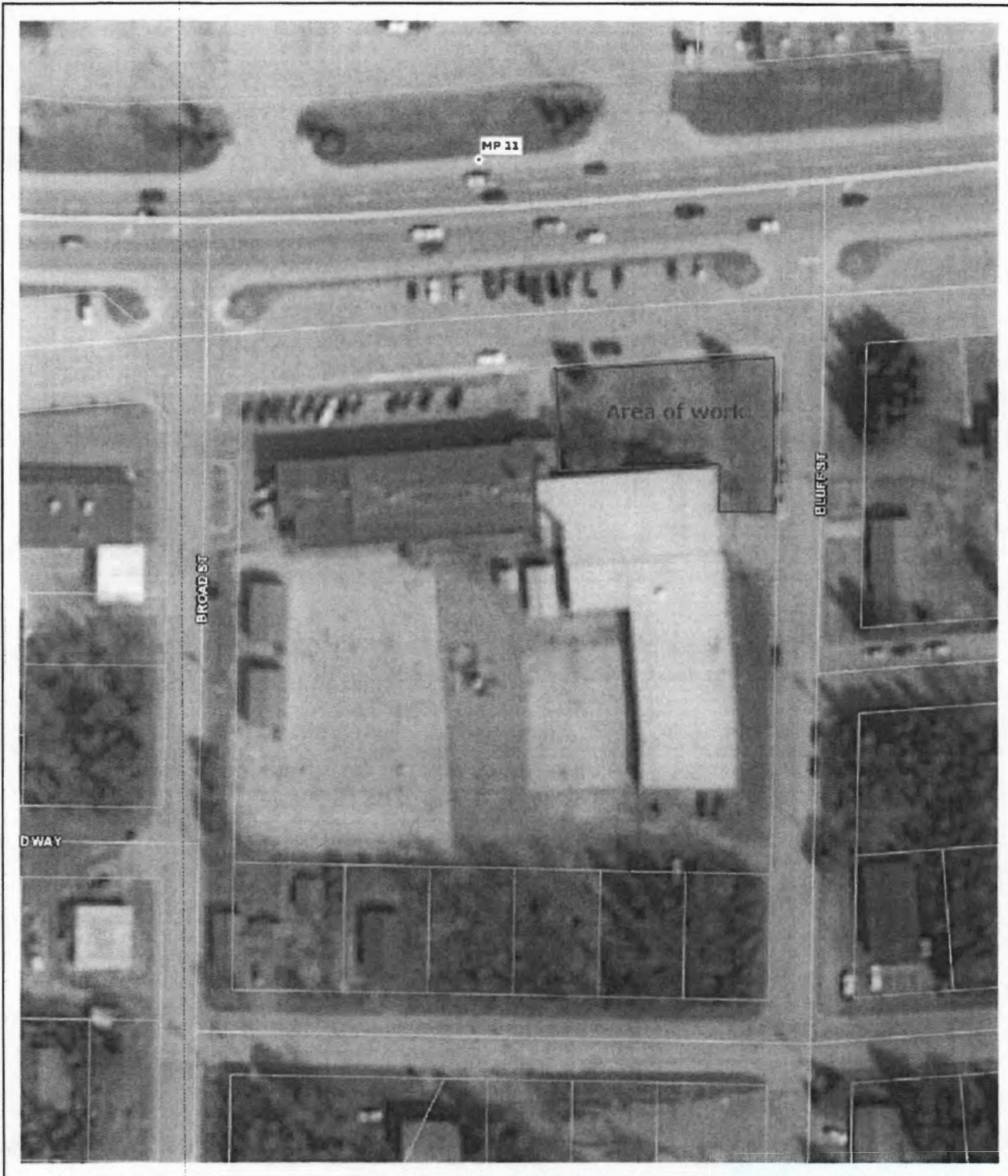

## KPB Parcel Viewer



Printed: Apr 20, 2015



FRONTAGE ROAD

10' LAIDS  
5' SIDEWALK DRY WELL

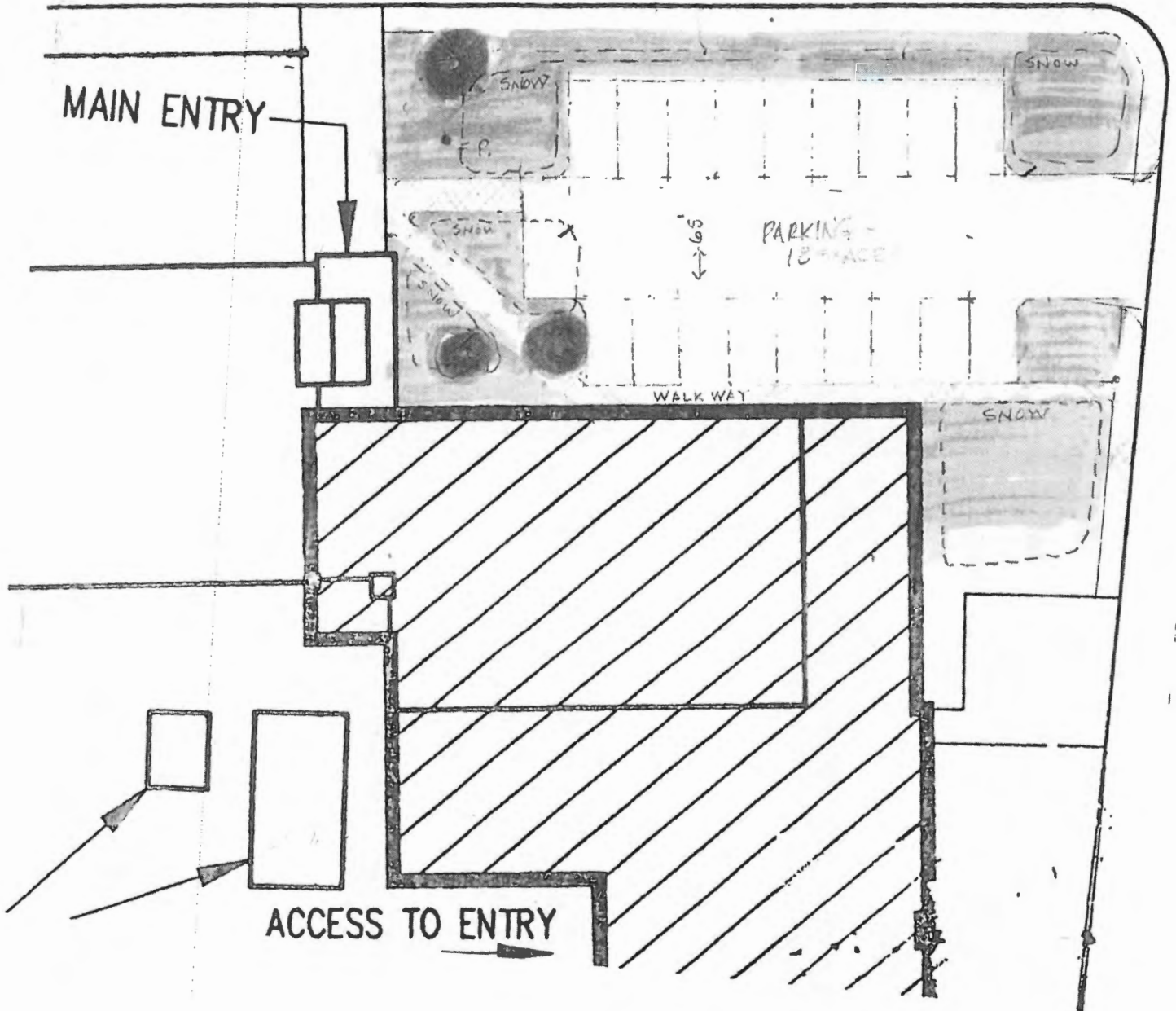

## ACCOUNT ACTIVITY DETAILS REPORT

11:06:42 AM | 04/28/2015

GLESLINE FOR BEGINNING BALANCE TO APRIL, 2015

Process ID: 167493

ACCOUNT NO				ACCOUNT NAME			SHORT NAME				
TY	DATE	DOC NO	DESCRIPTION	PO NO	CHECK NO	PAYEE/PAYER NAME	BUD ADJ	ENCUMB	DEBIT	CREDIT	
Fund : OPERATING FUND [100]											
Location : BOARD OF EDUCATION [70]											
100-70-4511-0000-3240				100-70-SCH BOARD-GENL-SUPPT STAFF							
JE	07/31/2014	15500112	PAYROLL - 07/31/2014				0.00	0.00	2,786.08	0.00	
JE	08/29/2014	15500824	PAYROLL - 08/29/2014				0.00	0.00	2,968.84	0.00	
JE	09/30/2014	15501770	PAYROLL - 09/30/2014				0.00	0.00	2,710.68	0.00	
JE	10/31/2014	15502803	PAYROLL - 10/31/2014				0.00	0.00	2,839.76	0.00	
JE	11/26/2014	15503627	PAYROLL - 11/26/2014				0.00	0.00	2,839.76	0.00	
JE	12/31/2014	15504356	PAYROLL - 12/31/2014				0.00	0.00	2,710.68	0.00	
BA	01/13/2015	436	BR 1/12/15				-3.00	0.00	0.00	0.00	
JE	01/30/2015	15505186	PAYROLL - 01/30/2015				0.00	0.00	3,073.72	0.00	
JE	02/27/2015	15506079	PAYROLL - 02/27/2015				0.00	0.00	2,581.60	0.00	
JE	03/31/2015	15506915	PAYROLL - 03/31/2015				0.00	0.00	2,581.60	0.00	
BA	04/17/2015	849	Non-certified salaries aligned to				1,366.00	0.00	0.00	0.00	
ACCOUNT SUMMARY				BUDG/BAL	ADJ. BUDGET	REQUISITION	ENCUMB	CURR DR/CR	YTD DR/CR	CURR BAL	PCT
100-70-4511-0000-3240				33,435.00	34,798.00	0.00	9,705.20	25,092.72	25,092.72	0.08	0.00
100-70-4511-0000-3291				100-70-SCH BOARD-GENL-SUB/SUPPT							
BA	01/13/2015	438	BR 1/12/15				16.00	0.00	0.00	0.00	
ACCOUNT SUMMARY				BUDG/BAL	ADJ. BUDGET	REQUISITION	ENCUMB	CURR DR/CR	YTD DR/CR	CURR BAL	PCT
100-70-4511-0000-3291				336.00	352.00	0.00	0.00	0.00	0.00	352.00	100.00
100-70-4511-0000-3295				100-70-SCH BOARD-GENL-OT SUPPT							
JE	11/26/2014	15503627	PAYROLL - 11/26/2014				0.00	0.00	84.71	0.00	
JE	02/27/2015	15506079	PAYROLL - 02/27/2015				0.00	0.00	72.61	0.00	
ACCOUNT SUMMARY				BUDG/BAL	ADJ. BUDGET	REQUISITION	ENCUMB	CURR DR/CR	YTD DR/CR	CURR BAL	PCT
100-70-4511-0000-3295				0.00	0.00	0.00	0.00	157.32	157.32	-157.32	0.00
100-70-4511-0000-3296				100-70-SCH BOARD-GENL-SUB CERT WO							
JE	02/27/2015	15506079	PAYROLL - 02/27/2015				0.00	0.00	239.97	0.00	
ACCOUNT SUMMARY				BUDG/BAL	ADJ. BUDGET	REQUISITION	ENCUMB	CURR DR/CR	YTD DR/CR	CURR BAL	PCT
100-70-4511-0000-3296				0.00	0.00	0.00	0.00	239.97	239.97	-239.97	0.00
100-70-4511-0000-3300				100-70-SCH BOARD-GENL-LEAVE/SUPPT							
ACCOUNT SUMMARY				BUDG/BAL	ADJ. BUDGET	REQUISITION	ENCUMB	CURR DR/CR	YTD DR/CR	CURR BAL	PCT
100-70-4511-0000-3300				566.00	566.00	0.00	0.00	0.00	0.00	566.00	100.00
100-70-4511-0000-3511				100-70-SCH BOARD-GENL-HEALTH CARE							
JE	07/31/2014	15500113	BENEFITS - 07/31/2014				0.00	0.00	710.15	0.00	
JE	08/29/2014	15500825	BENEFITS - 08/29/2014				0.00	0.00	710.07	0.00	
JE	09/30/2014	15501771	BENEFITS - 09/30/2014				0.00	0.00	710.07	0.00	
JE	10/31/2014	15502804	BENEFITS - 10/31/2014				0.00	0.00	710.07	0.00	
JE	11/26/2014	15503628	BENEFITS - 11/26/2014				0.00	0.00	29,113.07	0.00	
JE	12/31/2014	15504355	BENEFITS - 12/31/2014				0.00	0.00	6,390.67	0.00	
BA	01/13/2015	442	BR 1/12/15				171.00	0.00	0.00	0.00	
JE	01/30/2015	15505185	BENEFITS - 01/30/2015				0.00	0.00	6,390.67	0.00	
JE	02/27/2015	15506078	BENEFITS - 02/27/2015				0.00	0.00	6,390.67	0.00	

## ACCOUNT ACTIVITY DETAILS REPORT

GLEXLINE FOR BEGINNING BALANCE TO APRIL, 2015

11:06:42 AM | 04/28/2015

Process ID: 167493

ACCOUNT NO			ACCOUNT NAME			SHORT NAME				
TY	DATE	DOC NO	DESCRIPTION	PO NO	CHECK NO	PAYEE/PAYER NAME	BUD ADJ	ENCUMB	DEBIT	CREDIT
<b>Fund : OPERATING FUND [100]</b>										
<b>Location : BOARD OF EDUCATION [70]</b>										
JE	03/31/2015	15506914	BENEFITS - 03/31/2015				0.00	0.00	6,390.67	0.00
<b>ACCOUNT SUMMARY</b>				<b>BUDG/BAL</b>	<b>ADJ. BUDGET</b>	<b>REQUISITION</b>	<b>ENCUMB</b>	<b>CURR DR/CR</b>	<b>YTD DR/CR</b>	<b>CURR BAL</b>
<b>100-70-4511-0000-3511</b>				<b>76,518.00</b>	<b>76,689.00</b>	<b>0.00</b>	<b>2,130.23</b>	<b>57,516.11</b>	<b>57,516.11</b>	<b>17,042.66</b>
<b>100-70-4511-0000-3512</b>				<b>100-70-SCH BOARD-GENL-LIFE INS</b>						
JE	07/31/2014	15500113	BENEFITS - 07/31/2014				0.00	0.00	4.52	0.00
JE	08/29/2014	15500825	BENEFITS - 08/29/2014				0.00	0.00	4.52	0.00
JE	09/30/2014	15501771	BENEFITS - 09/30/2014				0.00	0.00	4.52	0.00
JE	10/31/2014	15502804	BENEFITS - 10/31/2014				0.00	0.00	4.52	0.00
JE	11/26/2014	15503628	BENEFITS - 11/26/2014				0.00	0.00	4.52	0.00
JE	12/31/2014	15504355	BENEFITS - 12/31/2014				0.00	0.00	4.52	0.00
BA	01/13/2015	444	BR 1/12/15				2.00	0.00	0.00	0.00
JE	01/30/2015	15505185	BENEFITS - 01/30/2015				0.00	0.00	4.52	0.00
JE	02/27/2015	15506078	BENEFITS - 02/27/2015				0.00	0.00	4.52	0.00
JE	03/31/2015	15506914	BENEFITS - 03/31/2015				0.00	0.00	4.52	0.00
<b>ACCOUNT SUMMARY</b>				<b>BUDG/BAL</b>	<b>ADJ. BUDGET</b>	<b>REQUISITION</b>	<b>ENCUMB</b>	<b>CURR DR/CR</b>	<b>YTD DR/CR</b>	<b>CURR BAL</b>
<b>100-70-4511-0000-3512</b>				<b>98.00</b>	<b>100.00</b>	<b>0.00</b>	<b>13.58</b>	<b>40.68</b>	<b>40.68</b>	<b>45.74</b>
<b>100-70-4511-0000-3520</b>				<b>100-70-SCH BOARD-GENL-UNEMPLT INS</b>						
BA	01/13/2015	445	BR 1/12/15				1.00	0.00	0.00	0.00
<b>ACCOUNT SUMMARY</b>				<b>BUDG/BAL</b>	<b>ADJ. BUDGET</b>	<b>REQUISITION</b>	<b>ENCUMB</b>	<b>CURR DR/CR</b>	<b>YTD DR/CR</b>	<b>CURR BAL</b>
<b>100-70-4511-0000-3520</b>				<b>99.00</b>	<b>100.00</b>	<b>0.00</b>	<b>0.00</b>	<b>0.00</b>	<b>0.00</b>	<b>100.00</b>
<b>100-70-4511-0000-3542</b>				<b>100-70-SCH BOARD-GENL-FICA SUPPRT</b>						
JE	07/31/2014	15500113	BENEFITS - 07/31/2014				0.00	0.00	332.83	0.00
JE	08/29/2014	15500825	BENEFITS - 08/29/2014				0.00	0.00	346.78	0.00
JE	09/30/2014	15501771	BENEFITS - 09/30/2014				0.00	0.00	327.04	0.00
JE	10/31/2014	15502804	BENEFITS - 10/31/2014				0.00	0.00	336.91	0.00
JE	11/26/2014	15503628	BENEFITS - 11/26/2014				0.00	0.00	343.41	0.00
JE	12/31/2014	15504355	BENEFITS - 12/31/2014				0.00	0.00	327.04	0.00
BA	01/13/2015	447	BR 1/12/15				51.00	0.00	0.00	0.00
JE	01/30/2015	15505185	BENEFITS - 01/30/2015				0.00	0.00	354.94	0.00
JE	02/27/2015	15506078	BENEFITS - 02/27/2015				0.00	0.00	341.23	0.00
JE	03/31/2015	15506914	BENEFITS - 03/31/2015				0.00	0.00	317.29	0.00
<b>ACCOUNT SUMMARY</b>				<b>BUDG/BAL</b>	<b>ADJ. BUDGET</b>	<b>REQUISITION</b>	<b>ENCUMB</b>	<b>CURR DR/CR</b>	<b>YTD DR/CR</b>	<b>CURR BAL</b>
<b>100-70-4511-0000-3542</b>				<b>2,533.00</b>	<b>2,584.00</b>	<b>0.00</b>	<b>742.45</b>	<b>3,027.47</b>	<b>3,027.47</b>	<b>-1,185.92</b>
<b>100-70-4511-0000-3560</b>				<b>100-70-SCH BOARD-GENL-PERS RETIREM</b>						
JE	07/31/2014	15500113	BENEFITS - 07/31/2014				0.00	0.00	1,031.01	0.00
JE	08/29/2014	15500825	BENEFITS - 08/29/2014				0.00	0.00	1,071.14	0.00
JE	09/30/2014	15501771	BENEFITS - 09/30/2014				0.00	0.00	1,014.35	0.00
JE	10/31/2014	15502804	BENEFITS - 10/31/2014				0.00	0.00	1,042.74	0.00
JE	11/26/2014	15503628	BENEFITS - 11/26/2014				0.00	0.00	1,061.45	0.00
JE	12/31/2014	15504355	BENEFITS - 12/31/2014				0.00	0.00	1,014.35	0.00

## ACCOUNT ACTIVITY DETAILS REPORT

GLESLINE FOR BEGINNING BALANCE TO APRIL, 2015

11:06:42 AM | 04/28/2015

Process ID: 167493

ACCOUNT NO			ACCOUNT NAME			SHORT NAME				
TY	DATE	DOC NO	DESCRIPTION	PO NO	CHECK NO	PAYEE/PAYER NAME	BUD ADJ	ENCUMB	DEBIT	CREDIT
<b>Fund : OPERATING FUND [100]</b>										
<b>Location : BOARD OF EDUCATION [70]</b>										
BA	01/13/2015	449	BR 1/12/15				144.00	0.00	0.00	0.00
JE	01/30/2015	15505185	BENEFITS - 01/30/2015				0.00	0.00	1,094.22	0.00
JE	02/27/2015	15506078	BENEFITS - 02/27/2015				0.00	0.00	1,001.98	0.00
JE	03/31/2015	15506914	BENEFITS - 03/31/2015				0.00	0.00	985.95	0.00
<b>ACCOUNT SUMMARY</b>				<b>BUDG/BAL</b>	<b>ADJ. BUDGET</b>	<b>REQUISITION</b>	<b>ENCUMB</b>	<b>CURR DR/CR</b>	<b>YTD DR/CR</b>	<b>CURR BAL</b>
<b>100-70-4511-0000-3560</b>				<b>7,211.00</b>	<b>7,355.00</b>	<b>0.00</b>	<b>2,135.14</b>	<b>9,317.19</b>	<b>9,317.19</b>	<b>-4,097.33</b>
<b>100-70-4511-0000-4140</b>				<b>100-70-SCH BOARD-GENL-PRO-TECH LEG</b>						
AP	07/23/2014	15300583	193052 - Legal fees - June 2014		191655	JERMAIN DUNNAGAN &	0.00	0.00	9,835.09	0.00
AP	07/23/2014	15300583	193052 - Legal fees - June 2014		191655	JERMAIN DUNNAGAN &	0.00	0.00	-9,835.09	0.00
AP	07/23/2014	15300583	193052 - Legal fees - June 2014		191655	JERMAIN DUNNAGAN &	0.00	0.00	9,835.09	0.00
JE	07/30/2014	15500129	FY14 AP LISTING 5 - REVERSAL				0.00	0.00	0.00	9,835.09
AP	08/20/2014	15302404	193184 - Legal fees - July 2014		192238	JERMAIN DUNNAGAN &	0.00	0.00	2,330.30	0.00
AP	08/20/2014	15302404	193184 - Legal fees - July 2014		192238	JERMAIN DUNNAGAN &	0.00	0.00	-2,330.30	0.00
AP	08/20/2014	15302404	193184 - Legal fees - July 2014		192238	JERMAIN DUNNAGAN &	0.00	0.00	2,330.30	0.00
AP	09/25/2014	15307293	193536 - Legal Fee - August 2014			JERMAIN DUNNAGAN &	0.00	0.00	6,163.00	0.00
AP	09/25/2014	15307293	193536 - Legal Fee - August 2014			JERMAIN DUNNAGAN &	0.00	0.00	-6,163.00	0.00
AP	10/08/2014	15307293	193536 - Legal Fee - August 2014		194251	JERMAIN DUNNAGAN &	0.00	0.00	6,163.00	0.00
AP	10/08/2014	15307293	193536 - Legal Fee - August 2014		194251	JERMAIN DUNNAGAN &	0.00	0.00	-6,163.00	0.00
AP	10/08/2014	15307293	193536 - Legal Fee - August 2014		194251	JERMAIN DUNNAGAN &	0.00	0.00	6,163.00	0.00
AP	10/22/2014	15311326	193615 - Legal Fees-Sept. 2014		195009	JERMAIN DUNNAGAN &	0.00	0.00	7,816.51	0.00
AP	11/19/2014	15316870	193863 - Legal fees October 2014		196479	JERMAIN DUNNAGAN &	0.00	0.00	2,107.15	0.00
AP	12/17/2014	15321790	194056 - Legal fees-November		197579	JERMAIN DUNNAGAN &	0.00	0.00	9,302.52	0.00
AP	01/06/2015	15323824	11116311 - Brighton, David Ref.			AMERICAN ARBITRATION	0.00	0.00	250.00	0.00
AP	01/06/2015	15323824	11116311 - Brighton, David Ref.			AMERICAN ARBITRATION	0.00	0.00	-250.00	0.00
AP	01/14/2015	15323824	11116311 - CASE 01-14-0002-		198249	AMERICAN ARBITRATION	0.00	0.00	250.00	0.00
AP	01/21/2015	15325640	194281 - Legal fees - December		198623	JERMAIN DUNNAGAN &	0.00	0.00	7,925.45	0.00
AP	02/18/2015	15329265	194501 - Legal fees Jan. 2015		199796	JERMAIN DUNNAGAN &	0.00	0.00	25,505.42	0.00
AP	03/18/2015	15333604	194692 - Legal fees - February		200964	JERMAIN DUNNAGAN &	0.00	0.00	18,181.17	0.00
AP	04/08/2015	15336163	01-14-000-6205 - PROFESSIONAL		201851	KATHRYN T WHALEN,	0.00	0.00	4,941.28	0.00
AP	04/20/2015	15338495	194939 - Legal Fees-March 2015			JERMAIN DUNNAGAN &	0.00	0.00	7,246.75	0.00
<b>ACCOUNT SUMMARY</b>				<b>BUDG/BAL</b>	<b>ADJ. BUDGET</b>	<b>REQUISITION</b>	<b>ENCUMB</b>	<b>CURR DR/CR</b>	<b>YTD DR/CR</b>	<b>CURR BAL</b>
<b>100-70-4511-0000-4140</b>				<b>100,000.00</b>	<b>100,000.00</b>	<b>0.00</b>	<b>0.00</b>	<b>91,769.55</b>	<b>91,769.55</b>	<b>8,230.45</b>
<b>100-70-4511-0000-4201</b>				<b>100-70-SCH BOARD-GENL-MEALS</b>						
AP	07/08/2014	15300189	July 7, 2014 - 18 @ \$22.00			FERGUSON, LISA	0.00	0.00	396.00	0.00
AP	07/08/2014	15300189	July 7, 2014 - 18 @ \$22.00			FERGUSON, LISA	0.00	0.00	-396.00	0.00
AP	07/09/2014	15300042	3/21-3/26/14ME - TRAVEL -		191487	HOHL, LYNN	0.00	0.00	134.96	0.00
JE	07/15/2014	15500051	FY14 AP LISTING REVERSE				0.00	0.00	0.00	134.96
AP	09/10/2014	15304816	9/8/14ME - TRAVEL - MEALS		192973	CASTIMORE, DANIEL	0.00	0.00	16.00	0.00
AP	09/10/2014	15304847	9/8/14ME - TRAVEL - MEALS		193056	HOHL, LYNN	0.00	0.00	7.00	0.00
AP	09/10/2014	15305119	BATES, NATALIE - Board Meeting		1646	BMO MASTERCARD	0.00	0.00	162.91	0.00
JE	09/11/2014	15501254	Meals for School Board Meeting				0.00	0.00	660.00	0.00
AP	09/17/2014	15306114	9/11/14ME - TRAVEL - MEALS		193372	HOHL, LYNN	0.00	0.00	9.00	0.00



## ACCOUNT ACTIVITY DETAILS REPORT

GLESLINE FOR BEGINNING BALANCE TO APRIL, 2015

11:06:42 AM | 04/28/2015

Process ID: 167493

ACCOUNT NO			ACCOUNT NAME			SHORT NAME					
TY	DATE	DOC NO	DESCRIPTION	PO NO	CHECK NO	PAYEE/PAYER NAME	BUD ADJ	ENCUMB	DEBIT	CREDIT	
Fund : OPERATING FUND [100]											
Location : BOARD OF EDUCATION [70]											
ACCOUNT SUMMARY				BUDG/BAL	ADJ. BUDGET	REQUISITION	ENCUMB	CURR DR/CR	YTD DR/CR	CURR BAL	PCT
100-70-4511-0000-4201				3,750.00	3,750.00	0.00	0.00	3,529.29	3,529.29	220.71	5.89
100-70-4511-0000-4202				100-70-SCH BOARD-GENL-MILEAGE							
AP	07/09/2014	15300040	2/5/14 - TRAVEL - MILEAGE		191487	HOHL, LYNN	0.00	0.00	113.12	0.00	
AP	07/09/2014	15300041	3/21-3/26/14MI - TRAVEL -		191487	HOHL, LYNN	0.00	0.00	140.56	0.00	
AP	07/09/2014	15300202	7/7/14 - TRAVEL - MILEAGE		191460	CASTIMORE, DANIEL	0.00	0.00	6.72	0.00	
AP	07/09/2014	15300203	7/7/14 - TRAVEL - MILEAGE		191452	ARNESS, JOE	0.00	0.00	22.40	0.00	
AP	07/09/2014	15300204	7/7/14 - TRAVEL - MILEAGE		191473	DOWNING, ELIZABETH	0.00	0.00	84.00	0.00	
JE	07/15/2014	15500051	FY14 AP LISTING REVERSE				0.00	0.00	0.00	113.12	
JE	07/15/2014	15500051	FY14 AP LISTING REVERSE				0.00	0.00	0.00	140.56	
AP	07/30/2014	15300793	7/7/14 - TRAVEL - MILEAGE		191750	HILTS, EDITH-HELEN	0.00	0.00	84.00	0.00	
AP	08/06/2014	15301720	8/4/14 - TRAVEL - MILEAGE		191855	DOWNING, ELIZABETH	0.00	0.00	84.00	0.00	
AP	08/06/2014	15301721	8/4/14 - TRAVEL - MILEAGE		191872	HOHL, LYNN	0.00	0.00	103.04	0.00	
AP	08/06/2014	15301722	8/4/14 - TRAVEL - MILEAGE		191833	ARNESS, JOE	0.00	0.00	22.40	0.00	
AP	08/06/2014	15301723	8/4/14 - TRAVEL - MILEAGE		191841	CASTIMORE, DANIEL	0.00	0.00	6.72	0.00	
AP	08/06/2014	15301724	8/4/14 - TRAVEL - MILEAGE		191873	HOLT, WILLIAM	0.00	0.00	20.72	0.00	
AP	08/06/2014	15301725	8/5/14 - TRAVEL - MILEAGE		191855	DOWNING, ELIZABETH	0.00	0.00	5.60	0.00	
AP	08/06/2014	15301726	8/5/14 - TRAVEL - MILEAGE		191871	HILTS, EDITH-HELEN	0.00	0.00	5.60	0.00	
AP	08/06/2014	15301727	8/5/14 - TRAVEL - MILEAGE		191873	HOLT, WILLIAM	0.00	0.00	20.72	0.00	
AP	08/13/2014	15302082	8/5/14 - TRAVEL - MILEAGE		191941	ARNESS, JOE	0.00	0.00	22.40	0.00	
AP	08/20/2014	15302241	8/13/14 - TRAVEL - MILEAGE		192227	HOLT, WILLIAM	0.00	0.00	20.72	0.00	
AP	08/20/2014	15302529	8/4/14 - TRAVEL - MILEAGE		192221	HILTS, EDITH-HELEN	0.00	0.00	84.00	0.00	
AP	08/27/2014	15302864	8/14/14 - TRAVEL - MILEAGE		192477	HILTS, EDITH-HELEN	0.00	0.00	84.00	0.00	
AP	09/10/2014	15304815	9/8/14 - TRAVEL - MILEAGE		192946	ARNESS, JOE	0.00	0.00	115.36	0.00	
AP	09/10/2014	15304817	9/8/14MI - TRAVEL - MILEAGE		192973	CASTIMORE, DANIEL	0.00	0.00	89.60	0.00	
AP	09/10/2014	15304820	9/8/14 - TRAVEL - MILEAGE		193056	HOHL, LYNN	0.00	0.00	189.28	0.00	
AP	09/10/2014	15304821	9/8/14 - TRAVEL - MILEAGE		193057	HOLT, WILLIAM	0.00	0.00	72.80	0.00	
AP	09/10/2014	15304823	9/8/14 - TRAVEL - MILEAGE		192968	BRETT-VADLA, KAREN	0.00	0.00	84.00	0.00	
AP	09/17/2014	15306107	9/11/14 - TRAVEL - MILEAGE		193256	ARNESS, JOE	0.00	0.00	22.40	0.00	
AP	09/17/2014	15306109	9/11/14 - TRAVEL - MILEAGE		193292	CASTIMORE, DANIEL	0.00	0.00	10.08	0.00	
AP	09/17/2014	15306110	9/11/14 - TRAVEL - MILEAGE		193325	DOWNING, ELIZABETH	0.00	0.00	84.00	0.00	
AP	09/17/2014	15306115	9/11/14MI - TRAVEL - MILEAGE		193372	HOHL, LYNN	0.00	0.00	103.04	0.00	
AP	09/24/2014	15306956	9/11/14MI - TRAVEL - MILEAGE		193659	HILTS, EDITH-HELEN	0.00	0.00	84.00	0.00	
AP	10/29/2014	15312373	10/20-10/21/14 - TRAVEL -		195338	ARNESS, JOE	0.00	0.00	44.80	0.00	
AP	10/29/2014	15312375	10/20-10/21/14 - TRAVEL -		195369	CASTIMORE, DANIEL	0.00	0.00	13.44	0.00	
AP	10/29/2014	15312378	10/20-10/21/14 - TRAVEL -		195402	DOWNING, ELIZABETH	0.00	0.00	84.00	0.00	
AP	10/29/2014	15312382	10/20-10/21/14 - TRAVEL -		195445	HOLT, WILLIAM	0.00	0.00	41.44	0.00	
AP	10/29/2014	15312383	7/7/14 - TRAVEL - MILEAGE		195443	HOHL, LYNN	0.00	0.00	103.04	0.00	
AP	10/29/2014	15312384	10/20-10/21/14 - TRAVEL -		195443	HOHL, LYNN	0.00	0.00	103.04	0.00	
AP	10/29/2014	15312385	10/20-10/21/14 - TRAVEL -		195477	KULIKOV, AKCINIA	0.00	0.00	114.24	0.00	
AP	10/29/2014	15312777	10/20-10/21/14 - TRAVEL -		195442	HILTS, EDITH-HELEN	0.00	0.00	84.00	0.00	
AP	11/05/2014	15314386	11/3/14 - TRAVEL - MILEAGE		195671	ARNESS, JOE	0.00	0.00	22.40	0.00	

## ACCOUNT ACTIVITY DETAILS REPORT

GLESLINE FOR BEGINNING BALANCE TO APRIL, 2015

11:06:42 AM | 04/28/2015

Process ID: 167493

ACCOUNT NO		ACCOUNT NAME				SHORT NAME				
TY	DATE	DOC NO	DESCRIPTION	PO NO	CHECK NO	PAYEE/PAYER NAME	BUD ADJ	ENCUMB	DEBIT	CREDIT
Fund : OPERATING FUND [100]										
Location : BOARD OF EDUCATION [70]										
AP	11/05/2014	15314388	11/3/14 - TRAVEL - MILEAGE		195705	CASTIMORE, DANIEL	0.00	0.00	10.08	0.00
AP	11/05/2014	15314389	11/3/14 - TRAVEL - MILEAGE		195738	DOWNING, ELIZABETH	0.00	0.00	84.00	0.00
AP	11/05/2014	15314390	11/3/14 - TRAVEL - MILEAGE		195808	HOHL, LYNN	0.00	0.00	103.04	0.00
AP	11/05/2014	15314391	11/3/14 - TRAVEL - MILEAGE		195812	HOLT, WILLIAM	0.00	0.00	20.72	0.00
AP	11/05/2014	15314393	11/3/14 - TRAVEL - MILEAGE		195848	KULIKOV, AKCINIA	0.00	0.00	114.24	0.00
AP	11/12/2014	15316284	10/30-10/31/14 - TRAVEL -		196056	BRETT-VADLA, KAREN	0.00	0.00	45.36	0.00
AP	11/19/2014	15317231	11/3/14 - TRAVEL - MILEAGE		196467	HILTS, EDITH-HELEN	0.00	0.00	164.64	0.00
AP	12/10/2014	15319527	12/1-12/2/14 - TRAVEL - MILEAGE		197197	ARNESS, JOE	0.00	0.00	44.80	0.00
AP	12/10/2014	15319530	12/1-12/2/14 - TRAVEL - MILEAGE		197218	CASTIMORE, DANIEL	0.00	0.00	11.20	0.00
AP	12/10/2014	15319536	12/1-12/2/14 - TRAVEL - MILEAGE		197247	DOWNING, ELIZABETH	0.00	0.00	84.00	0.00
AP	12/10/2014	15319552	12/1-12/2/14 - TRAVEL - MILEAGE		197284	HILTS, EDITH-HELEN	0.00	0.00	84.00	0.00
AP	12/10/2014	15319553	12/1-12/2/14 - TRAVEL - MILEAGE		197286	HOLT, WILLIAM	0.00	0.00	41.44	0.00
AP	12/10/2014	15319555	12/1/14 - TRAVEL - MILEAGE		197306	KULIKOV, AKCINIA	0.00	0.00	114.24	0.00
AP	12/10/2014	15319597	12/1-12/2/14 - TRAVEL - MILEAGE		197285	HOHL, LYNN	0.00	0.00	103.04	0.00
AP	12/17/2014	15321942	12/11-12/12/14 - TRAVEL -		197723	TRESSLER, DEBRA	0.00	0.00	168.00	0.00
AP	12/31/2014	15323303	12/11-12/14MI - TRAVEL -		197957	HILTS, EDITH-HELEN	0.00	0.00	33.60	0.00
AP	01/21/2015	15325772	1/12/15 - TRAVEL - MILEAGE		198553	ARNESS, JOE	0.00	0.00	23.00	0.00
AP	01/21/2015	15325775	1/12/15 - TRAVEL - MILEAGE		198567	CASTIMORE, DANIEL	0.00	0.00	10.35	0.00
AP	01/21/2015	15325779	1/12/15 - TRAVEL - MILEAGE		198587	DOWNING, ELIZABETH	0.00	0.00	86.25	0.00
AP	01/21/2015	15325789	1/12/15 - TRAVEL - MILEAGE		198614	HOHL, LYNN	0.00	0.00	105.80	0.00
AP	01/21/2015	15325790	1/12/15 - TRAVEL - MILEAGE		198616	HOLT, WILLIAM	0.00	0.00	21.28	0.00
AP	01/21/2015	15325807	1/15/15 - TRAVEL - MILEAGE		198639	KULIKOV, AKCINIA	0.00	0.00	117.30	0.00
AP	01/28/2015	15326398	1/12/15 - TRAVEL - MILEAGE		198843	HILTS, EDITH-HELEN	0.00	0.00	86.25	0.00
AP	02/11/2015	15327849	2/2/15 - TRAVEL - MILEAGE		199419	ARNESS, JOE	0.00	0.00	23.00	0.00
AP	02/11/2015	15327855	2/2/15 - TRAVEL - MILEAGE		199448	CASTIMORE, DANIEL	0.00	0.00	10.35	0.00
AP	02/11/2015	15327859	1/20-1/21/15 - TRAVEL - MILEAGE		199527	HOHL, LYNN	0.00	0.00	121.90	0.00
AP	02/11/2015	15327876	2/2/15 - TRAVEL - MILEAGE		199479	DOWNING, ELIZABETH	0.00	0.00	86.25	0.00
AP	02/11/2015	15327881	2/2/15 - TRAVEL - MILEAGE		199527	HOHL, LYNN	0.00	0.00	105.80	0.00
AP	02/11/2015	15327882	2/2/15 - TRAVEL - MILEAGE		199529	HOLT, WILLIAM	0.00	0.00	21.28	0.00
AP	02/18/2015	15329159	2/2/15 - TRAVEL - MILEAGE		199783	HILTS, EDITH-HELEN	0.00	0.00	86.25	0.00
AP	02/25/2015	15329957	2/18/15 - TRAVEL - MILEAGE		199991	CASTIMORE, DANIEL	0.00	0.00	10.35	0.00
AP	02/25/2015	15329974	2/18/15 - TRAVEL - MILEAGE		199959	ARNESS, JOE	0.00	0.00	32.20	0.00
AP	02/25/2015	15329981	2/18/15 - TRAVEL - MILEAGE		200014	DOWNING, ELIZABETH	0.00	0.00	86.25	0.00
AP	03/04/2015	15331163	2/17/15 - TRAVEL - MILEAGE		200270	CASTIMORE, DANIEL	0.00	0.00	113.85	0.00
AP	03/04/2015	15331167	3/2/15 - TRAVEL - MILEAGE		200237	ARNESS, JOE	0.00	0.00	23.00	0.00
AP	03/04/2015	15331169	3/2/15 - TRAVEL - MILEAGE		200270	CASTIMORE, DANIEL	0.00	0.00	10.35	0.00
AP	03/04/2015	15331171	3/2/15 - TRAVEL - MILEAGE		200305	DOWNING, ELIZABETH	0.00	0.00	86.25	0.00
AP	03/04/2015	15331180	2/24/15 - TRAVEL - MILEAGE		200365	HOHL, LYNN	0.00	0.00	194.35	0.00
AP	03/04/2015	15331181	3/2/15 - TRAVEL - MILEAGE		200365	HOHL, LYNN	0.00	0.00	105.80	0.00
AP	03/04/2015	15331182	3/2/15 - TRAVEL - MILEAGE		200370	HOLT, WILLIAM	0.00	0.00	21.28	0.00
AP	03/04/2015	15331183	2/18/15 - TRAVEL - MILEAGE		200370	HOLT, WILLIAM	0.00	0.00	23.00	0.00
AP	03/04/2015	15331186	3/2/15 - TRAVEL - MILEAGE		200410	KULIKOV, AKCINIA	0.00	0.00	117.30	0.00

## ACCOUNT ACTIVITY DETAILS REPORT

GLEXLNE FOR BEGINNING BALANCE TO APRIL, 2015

11:06:42 AM | 04/28/2015

Process ID: 167493

ACCOUNT NO			ACCOUNT NAME			SHORT NAME					
TY	DATE	DOC NO	DESCRIPTION	PO NO	CHECK NO	PAYEE/PAYER NAME	BUD ADJ	ENCUMB	DEBIT	CREDIT	
Fund : OPERATING FUND [100]											
Location : BOARD OF EDUCATION [70]											
AP	03/11/2015	15332991	3/3/15 - TRAVEL - MILEAGE		200594	ARNESS, JOE	0.00	0.00	23.00	0.00	
AP	03/11/2015	15332998	3/3/15 - TRAVEL - MILEAGE		200625	CASTIMORE, DANIEL	0.00	0.00	10.35	0.00	
AP	03/25/2015	15334444	3/17/15 - TRAVEL - MILEAGE		201108	ARNESS, JOE	0.00	0.00	23.00	0.00	
AP	03/25/2015	15334448	3/17/15 - TRAVEL - MILEAGE		201128	CASTIMORE, DANIEL	0.00	0.00	10.35	0.00	
AP	03/25/2015	15334452	3/17/15 - TRAVEL - MILEAGE		201161	DOWNING, ELIZABETH	0.00	0.00	86.25	0.00	
AP	03/25/2015	15334464	3/2/15 - TRAVEL - MILEAGE		201201	HILTS, EDITH-HELEN	0.00	0.00	86.25	0.00	
BA	03/30/2015	763	To purchase regular board				500.00	0.00	0.00	0.00	
AP	04/01/2015	15334761	3/17/15 - TRAVEL - MILEAGE		201506	HILTS, EDITH-HELEN	0.00	0.00	43.13	0.00	
AP	04/01/2015	15335689	1/20/15 - TRAVEL - MILEAGE		201419	BRETT-VADLA, KAREN	0.00	0.00	13.80	0.00	
AP	04/08/2015	15336482	4/6/15 - TRAVEL - MILEAGE		201710	ARNESS, JOE	0.00	0.00	23.00	0.00	
AP	04/08/2015	15336483	4/6/15 - TRAVEL - MILEAGE		201742	CASTIMORE, DANIEL	0.00	0.00	10.35	0.00	
AP	04/08/2015	15336484	4/6/15 - TRAVEL - MILEAGE		201772	DOWNING, ELIZABETH	0.00	0.00	86.25	0.00	
AP	04/08/2015	15336488	4/6/15 - TRAVEL - MILEAGE		201830	HOHL, LYNN	0.00	0.00	105.80	0.00	
AP	04/08/2015	15336489	4/6/15 - TRAVEL - MILEAGE		201832	HOLT, WILLIAM	0.00	0.00	21.28	0.00	
AP	04/08/2015	15336491	4/6/15 - TRAVEL - MILEAGE		201862	KULIKOV, AKCINIA	0.00	0.00	117.30	0.00	
AP	04/22/2015	15338778	4/6/15 - TRAVEL - MILEAGE		45	HILTS, EDITH-HELEN	0.00	0.00	86.25	0.00	
ACCOUNT SUMMARY				BUDG/BAL	ADJ. BUDGET	REQUISITION	ENCUMB	CURR DR/CR	YTD DR/CR	CURR BAL	PCT
100-70-4511-0000-4202				5,300.00	5,800.00	0.00	0.00	5,843.80	5,843.80	-43.80	-0.76
100-70-4511-0000-4203				100-70-SCH BOARD-GENL-OTHR TRVL							
AP	08/11/2014	15301941	HILTS, EDITH HELEN - Travel to		1637	BMO MASTERCARD	0.00	0.00	132.00	0.00	
AP	08/11/2014	15301953	HILTS, EDITH HELEN - Hotel fee for		1637	BMO MASTERCARD	0.00	0.00	149.00	0.00	
AP	09/10/2014	15305071	HILTS, EDITH HELEN - Board		1646	BMO MASTERCARD	0.00	0.00	40.85	0.00	
AP	09/10/2014	15305138	DOWNING, LIZ - Hotel charges-		1646	BMO MASTERCARD	0.00	0.00	189.00	0.00	
AP	09/10/2014	15305164	HILTS, EDITH HELEN - Hotel		1646	BMO MASTERCARD	0.00	0.00	179.00	0.00	
AP	09/10/2014	15305165	HILTS, EDITH HELEN - Airfare to		1646	BMO MASTERCARD	0.00	0.00	66.00	0.00	
AP	09/10/2014	15305198	HILTS, EDITH HELEN - Hotel		1646	BMO MASTERCARD	0.00	0.00	106.43	0.00	
AP	09/10/2014	15305589	HILTS, EDITH HELEN - Airfare for		1646	BMO MASTERCARD	0.00	0.00	132.00	0.00	
AP	09/12/2014	15306103	169839 - Hotel charges/50th			ASPEN HOTEL, SOLDOTNA	0.00	0.00	159.00	0.00	
AP	09/12/2014	15306103	169839 - Hotel charges/50th			ASPEN HOTEL, SOLDOTNA	0.00	0.00	-159.00	0.00	
AP	09/17/2014	15306103	169839 - Hotel charges/50th		193258	ASPEN HOTEL, SOLDOTNA	0.00	0.00	159.00	0.00	
AP	10/10/2014	15309844	HOHL, LYNN - Hotel for brd mtg-		1653	BMO MASTERCARD	0.00	0.00	89.10	0.00	
AP	10/10/2014	15309921	HILTS, EDITH HELEN - Hotel-board		1653	BMO MASTERCARD	0.00	0.00	99.00	0.00	
AP	10/10/2014	15310099	HILTS, EDITH HELEN - Travel to		1653	BMO MASTERCARD	0.00	0.00	132.00	0.00	
AP	10/10/2014	15310247	HILTS, EDITH HELEN - Travel to		1653	BMO MASTERCARD	0.00	0.00	132.00	0.00	
AP	12/10/2014	15319397	15854 - KULIKOV, MARIA		197198	ASSOCIATION OF ALASKA	0.00	0.00	300.00	0.00	
AP	12/10/2014	15319397	15854 - KULIKOV, AKCINIA		197198	ASSOCIATION OF ALASKA	0.00	0.00	300.00	0.00	
AP	12/11/2014	15319994	HILTS, EDITH HELEN - Ferry for		1670	BMO MASTERCARD	0.00	0.00	40.00	0.00	
AP	12/11/2014	15320061	DOWNING, LIZ - Hotel-Oct. brd		1670	BMO MASTERCARD	0.00	0.00	79.00	0.00	
AP	12/11/2014	15320062	HILTS, EDITH HELEN - Hotel Oct.		1670	BMO MASTERCARD	0.00	0.00	79.00	0.00	
AP	12/11/2014	15320063	HILTS, EDITH HELEN - Airfare Oct.		1670	BMO MASTERCARD	0.00	0.00	66.00	0.00	
AP	12/11/2014	15320084	HOHL, LYNN - Hotel Oct. brd mtg		1670	BMO MASTERCARD	0.00	0.00	79.00	0.00	
AP	12/11/2014	15320759	DOWNING, LIZ - Hotel-Nov. brd		1670	BMO MASTERCARD	0.00	0.00	79.00	0.00	



## ACCOUNT ACTIVITY DETAILS REPORT

GLEXLINE FOR BEGINNING BALANCE TO APRIL, 2015

11:06:42 AM | 04/28/2015

Process ID: 167493

ACCOUNT NO		ACCOUNT NAME				SHORT NAME				
TY	DATE	DOC NO	DESCRIPTION	PO NO	CHECK NO	PAYEE/PAYER NAME	BUD ADJ	ENCUMB	DEBIT	CREDIT
Fund : OPERATING FUND [100]										
Location : BOARD OF EDUCATION [70]										
AP	12/11/2014	15320760	DOWNING, LIZ - Hotel-Nov. brd		1670	BMO MASTERCARD	0.00	0.00	79.00	0.00
AP	12/11/2014	15320773	HILTS, EDITH HELEN - Hotel Nov.		1670	BMO MASTERCARD	0.00	0.00	79.00	0.00
AP	12/11/2014	15321039	TRESSLER, DEBBIE - Hotel-AASB		1670	BMO MASTERCARD	0.00	0.00	388.00	0.00
AP	12/17/2014	15321901	15882 - Tressler registration-Exec.		197450	ASSOCIATION OF ALASKA	0.00	0.00	375.00	0.00
AP	01/09/2015	15324361	HILTS, EDITH HELEN - Airfare to		1678	BMO MASTERCARD	0.00	0.00	132.00	0.00
AP	01/09/2015	15324409	DOWNING, LIZ - Hotel - Dec. brd		1678	BMO MASTERCARD	0.00	0.00	79.00	0.00
AP	01/09/2015	15324410	DOWNING, LIZ - Hotel-brd mtg-		1678	BMO MASTERCARD	0.00	0.00	79.00	0.00
AP	01/09/2015	15324411	HILTS, EDITH HELEN - Hotel Dec		1678	BMO MASTERCARD	0.00	0.00	79.00	0.00
AP	01/09/2015	15324670	HILTS, EDITH HELEN - Hotel K-Selo		1678	BMO MASTERCARD	0.00	0.00	106.42	0.00
AP	01/09/2015	15324778	HILTS, EDITH HELEN - Airfare K-		1678	BMO MASTERCARD	0.00	0.00	132.00	0.00
AP	01/09/2015	15324947	TRESSLER, DEBBIE - Hotel AASB		1678	BMO MASTERCARD	0.00	0.00	158.00	0.00
AP	02/10/2015	15328434	HILTS, EDITH HELEN - Hotel tax		1686	BMO MASTERCARD	0.00	0.00	-7.42	0.00
AP	02/10/2015	15328624	HILTS, EDITH HELEN - Airfare-Jan		1686	BMO MASTERCARD	0.00	0.00	66.00	0.00
AP	02/10/2015	15328709	HOHL, LYNN - Hotel fee-Jan brd		1686	BMO MASTERCARD	0.00	0.00	89.00	0.00
AP	02/10/2015	15328719	DOWNING, LIZ - Hotel charge-Jan.		1686	BMO MASTERCARD	0.00	0.00	79.00	0.00
AP	02/10/2015	15328720	HILTS, EDITH HELEN - Hotel-Jan		1686	BMO MASTERCARD	0.00	0.00	158.00	0.00
AP	02/10/2015	15328760	HILTS, EDITH HELEN - Airfare-Jan		1686	BMO MASTERCARD	0.00	0.00	66.00	0.00
AP	02/18/2015	15329140	2/7-2/10/15 - TRAVEL - OTHER		199687	ALLMENDINGER, RACHEL	0.00	0.00	52.00	0.00
AP	02/25/2015	15329655	16022 - Kulikov AASB YAI		199961	ASSOCIATION OF ALASKA	0.00	0.00	275.00	0.00
AP	02/25/2015	15329655	16022 - Allmendinger AASB		199961	ASSOCIATION OF ALASKA	0.00	0.00	275.00	0.00
AP	03/13/2015	15331444	HOHL, LYNN - Hotel-Committee		1693	BMO MASTERCARD	0.00	0.00	89.00	0.00
AP	03/13/2015	15331581	HOHL, LYNN - Hotel- Admin		1693	BMO MASTERCARD	0.00	0.00	84.00	0.00
AP	03/13/2015	15331709	DUSEK, SEAN - Airfare AASB YAI -		1693	BMO MASTERCARD	0.00	0.00	582.70	0.00
AP	03/13/2015	15331710	DUSEK, SEAN - Airfare AASB YAI		1693	BMO MASTERCARD	0.00	0.00	582.70	0.00
AP	03/13/2015	15332130	DOWNING, LIZ - Hotel Feb brd		1693	BMO MASTERCARD	0.00	0.00	79.00	0.00
AP	03/13/2015	15332169	HOHL, LYNN - Hotel Feb. brd. mtg-		1693	BMO MASTERCARD	0.00	0.00	89.00	0.00
AP	03/13/2015	15332195	HILTS, EDITH HELEN - Hotel-Feb.		1693	BMO MASTERCARD	0.00	0.00	79.00	0.00
AP	03/13/2015	15332530	TRESSLER, DEBBIE - Hotel AASB		1693	BMO MASTERCARD	0.00	0.00	560.00	0.00
AP	03/13/2015	15332546	HOHL, LYNN - Hotel AASB Fly-In		1693	BMO MASTERCARD	0.00	0.00	280.00	0.00
AP	03/13/2015	15332610	HOHL, LYNN - Hotel AASB Fly-In		1693	BMO MASTERCARD	0.00	0.00	700.00	0.00
AP	03/13/2015	15332793	HILTS, EDITH HELEN - Airfare-Feb.		1693	BMO MASTERCARD	0.00	0.00	132.00	0.00
AP	03/13/2015	15332851	DOWNING, LIZ - Hotel Feb special		1693	BMO MASTERCARD	0.00	0.00	79.00	0.00
AP	03/13/2015	15332931	HILTS, EDITH HELEN - Hotel-		1693	BMO MASTERCARD	0.00	0.00	158.00	0.00
BA	03/30/2015	764	To purchase board hotel, airfare,				2,000.00	0.00	0.00	0.00
AP	04/01/2015	15334763	3/20-3/24/15-A - TRAVEL - OTHER		201654	TRESSLER, DEBRA	0.00	0.00	1,143.76	0.00
AP	04/08/2015	15336478	3/28-3/31/15 - TRAVEL - OTHER		201828	HILTS, EDITH-HELEN	0.00	0.00	230.40	0.00
AP	04/10/2015	15336832	HILTS, EDITH HELEN - Airfare-Hilts		1700	BMO MASTERCARD	0.00	0.00	132.00	0.00
AP	04/10/2015	15337105	HILTS, EDITH HELEN - Airfare-Hilts		1700	BMO MASTERCARD	0.00	0.00	132.00	0.00
AP	04/10/2015	15337156	DOWNING, LIZ - Hotel for brd		1700	BMO MASTERCARD	0.00	0.00	79.00	0.00
AP	04/10/2015	15337173	HOHL, LYNN - Hotel brd mtg-Hohl		1700	BMO MASTERCARD	0.00	0.00	89.00	0.00
AP	04/10/2015	15337223	HILTS, EDITH HELEN - Hotel brd		1700	BMO MASTERCARD	0.00	0.00	158.00	0.00
AP	04/10/2015	15337474	HILTS, EDITH HELEN - Airfare to		1700	BMO MASTERCARD	0.00	0.00	66.00	0.00

## ACCOUNT ACTIVITY DETAILS REPORT

GLESLINE FOR BEGINNING BALANCE TO APRIL, 2015

11:06:42 AM | 04/28/2015

Process ID: 167493

ACCOUNT NO			ACCOUNT NAME			SHORT NAME					
TY	DATE	DOC NO	DESCRIPTION	PO NO	CHECK NO	PAYEE/PAYER NAME	BUD ADJ	ENCUMB	DEBIT	CREDIT	
Fund : OPERATING FUND [100]											
Location : BOARD OF EDUCATION [70]											
AP	04/10/2015	15337525	HILTS, EDITH HELEN - Hotel for		1700	BMO MASTERCARD	0.00	0.00	79.00	0.00	
AP	04/10/2015	15337593	HILTS, EDITH HELEN - Hotel-Hilts		1700	BMO MASTERCARD	0.00	0.00	95.20	0.00	
ACCOUNT SUMMARY				BUDG/BAL	ADJ. BUDGET	REQUISITION	ENCUMB	CURR DR/CR	YTD DR/CR	CURR BAL	PCT
100-70-4511-0000-4203				7,500.00	9,500.00	0.00	0.00	11,065.14	11,065.14	-1,565.14	-16.48
100-70-4511-0000-4331				100-70-SCH BOARD-GENL-POSTAGE							
ACCOUNT SUMMARY				BUDG/BAL	ADJ. BUDGET	REQUISITION	ENCUMB	CURR DR/CR	YTD DR/CR	CURR BAL	PCT
100-70-4511-0000-4331				200.00	200.00	0.00	0.00	0.00	0.00	200.00	100.00
100-70-4511-0000-4402				100-70-SCH BOARD-GENL-PURCH SVC							
PO	07/02/2014	1520413	Printing Services			KENAI PENINSULA BOROUGH	0.00	1,300.00	0.00	0.00	
PO	07/07/2014	1520427	Advertising Services			PENINSULA CLARION	0.00	4,000.00	0.00	0.00	
AP	07/16/2014	15300189	July 7, 2014 - 18 @ \$22.00		191550	FERGUSON, LISA	0.00	0.00	396.00	0.00	
AP	08/13/2014	15302136	D273/225 - Advertising Services	1520427	192035	PENINSULA CLARION	0.00	-170.80	170.80	0.00	
AP	08/27/2014	15302978	JULY POSTAGE - Printing Services	1520413	192491	KENAI PENINSULA BOROUGH	0.00	-128.82	128.82	0.00	
BA	09/09/2014	161	To purchase advertising for				373.00	0.00	0.00	0.00	
AP	09/17/2014	15305810	646423 - Advertising-Homer brd		193377	HOMER NEWS	0.00	0.00	372.90	0.00	
AP	09/24/2014	15306670	D274/225 - Advertising Services	1520427	193733	PENINSULA CLARION	0.00	-61.00	61.00	0.00	
AP	10/15/2014	15309073	SEPTEMBER POSTAGE - Printing	1520413	194602	KENAI PENINSULA BOROUGH	0.00	-52.22	52.22	0.00	
AP	10/29/2014	15312590	D275/225 - Advertising Services	1520427	195534	PENINSULA CLARION	0.00	-67.10	67.10	0.00	
AP	11/05/2014	15314049	D276/225 - Advertising Services	1520427	195896	PENINSULA CLARION	0.00	-42.70	42.70	0.00	
AP	12/03/2014	15318660	10/14 - Printing Services	1520413	197030	KENAI PENINSULA BOROUGH	0.00	-695.84	695.84	0.00	
JE	12/05/2014	15503923	PRINT SHOP PO				0.00	0.00	0.00	695.84	
JE	12/05/2014	15503923	PRINT SHOP PO				0.00	0.00	167.58	0.00	
AP	12/10/2014	15319382	D277/225 - Advertising Services	1520427	197348	PENINSULA CLARION	0.00	-67.10	67.10	0.00	
AP	01/07/2015	15323525	NOV POSTAGE - Printing Services	1520413	198142	KENAI PENINSULA BOROUGH	0.00	-77.06	77.06	0.00	
AP	02/11/2015	15328073	D503/225 - Advertising Services	1520427	199604	PENINSULA CLARION	0.00	-42.70	42.70	0.00	
AP	02/18/2015	15329098	JAN POSTAGE - Printing Services	1520413	199813	KENAI PENINSULA BOROUGH	0.00	-96.87	96.87	0.00	
AP	02/18/2015	15329399	D528/225 - Advertising Services	1520427	199871	PENINSULA CLARION	0.00	-42.70	42.70	0.00	
AP	03/11/2015	15333089	FEB CHARGES - Printing Services	1520413	200717	KENAI PENINSULA BOROUGH	0.00	-84.22	84.22	0.00	
AP	03/11/2015	15333524	D558/225 - Advertising Services	1520427	200769	PENINSULA CLARION	0.00	-42.70	42.70	0.00	
AP	03/11/2015	15333525	D566/225 - Advertising Services	1520427	200769	PENINSULA CLARION	0.00	-42.70	42.70	0.00	
AP	04/01/2015	15334634	D580/225 - Advertising Services	1520427	201590	PENINSULA CLARION	0.00	-73.20	73.20	0.00	
AP	04/15/2015	15338173	D611/225 - Advertising Services	1520427	202206	PENINSULA CLARION	0.00	-42.70	42.70	0.00	
AP	04/22/2015	15338770	3/31/15 - Printing Services	1520413	202416	KENAI PENINSULA BOROUGH	0.00	-70.74	70.74	0.00	
ACCOUNT SUMMARY				BUDG/BAL	ADJ. BUDGET	REQUISITION	ENCUMB	CURR DR/CR	YTD DR/CR	CURR BAL	PCT
100-70-4511-0000-4402				5,800.00	6,173.00	0.00	3,398.83	2,141.81	2,141.81	632.36	10.24
100-70-4511-0000-4501				100-70-SCH BOARD-GENL-SUPPLIES							
AP	08/11/2014	15301810	TRESSLER, DEBBIE -		1637	BMO MASTERCARD	0.00	0.00	29.95	0.00	
AP	08/11/2014	15301824	TRESSLER, DEBBIE - TAPE AND		1637	BMO MASTERCARD	0.00	0.00	49.96	0.00	
BA	09/09/2014	161	To purchase advertising for				-373.00	0.00	0.00	0.00	
AP	09/10/2014	15305065	TRESSLER, DEBBIE - Board		1646	BMO MASTERCARD	0.00	0.00	64.93	0.00	
AP	09/10/2014	15305183	TRESSLER, DEBBIE - Board		1646	BMO MASTERCARD	0.00	0.00	29.90	0.00	
AP	10/10/2014	15310065	TRESSLER, DEBBIE - Brd meeting		1653	BMO MASTERCARD	0.00	0.00	31.75	0.00	

## ACCOUNT ACTIVITY DETAILS REPORT

GLEXLINE FOR BEGINNING BALANCE TO APRIL, 2015

11:06:42 AM | 04/28/2015

Process ID: 167493

ACCOUNT NO			ACCOUNT NAME			SHORT NAME					
TY	DATE	DOC NO	DESCRIPTION	PO NO	CHECK NO	PAYEE/PAYER NAME	BUD ADJ	ENCUMB	DEBIT	CREDIT	
Fund : OPERATING FUND [100]											
Location : BOARD OF EDUCATION [70]											
JE	10/29/2014	15503717	** Warehouse Requisition **				0.00	0.00	5.98	0.00	
AP	11/10/2014	15314972	TRESSLER, DEBBIE - Headphones		1660	BMO MASTERCARD	0.00	0.00	43.00	0.00	
AP	11/10/2014	15315197	TRESSLER, DEBBIE - Board		1660	BMO MASTERCARD	0.00	0.00	18.89	0.00	
AP	11/10/2014	15315299	TRESSLER, DEBBIE - Student rep		1660	BMO MASTERCARD	0.00	0.00	20.00	0.00	
AP	11/10/2014	15315621	TRESSLER, DEBBIE - Office		1660	BMO MASTERCARD	0.00	0.00	28.46	0.00	
AP	11/12/2014	15314400	REIMBURSEMENT - Supplies for		196323	TRESSLER, DEBRA	0.00	0.00	54.44	0.00	
JE	12/08/2014	15504004	** Warehouse Requisition **				0.00	0.00	9.51	0.00	
AP	12/11/2014	15320038	TRESSLER, DEBBIE - Worksession		1670	BMO MASTERCARD	0.00	0.00	28.45	0.00	
AP	12/11/2014	15320083	TRESSLER, DEBBIE - Worksession		1670	BMO MASTERCARD	0.00	0.00	27.08	0.00	
AP	12/11/2014	15320375	TRESSLER, DEBBIE - Brd		1670	BMO MASTERCARD	0.00	0.00	17.76	0.00	
AP	12/11/2014	15320532	TRESSLER, DEBBIE - snacks		1670	BMO MASTERCARD	0.00	0.00	41.47	0.00	
AP	12/11/2014	15320707	TRESSLER, DEBBIE - Brd Supt		1670	BMO MASTERCARD	0.00	0.00	64.00	0.00	
JE	12/19/2014	15504322	** Warehouse Requisition **				0.00	0.00	11.64	0.00	
AP	12/23/2014	15322035	MU223942 - Board and		197833	LRP PUBLICATIONS	0.00	0.00	308.50	0.00	
AP	01/09/2015	15324002	TRESSLER, DEBBIE - Computer		1678	BMO MASTERCARD	0.00	0.00	32.95	0.00	
AP	01/09/2015	15324003	TRESSLER, DEBBIE - Computer		1678	BMO MASTERCARD	0.00	0.00	48.44	0.00	
AP	01/09/2015	15324457	TRESSLER, DEBBIE - Board		1678	BMO MASTERCARD	0.00	0.00	28.42	0.00	
AP	01/14/2015	15325516	GUS0099342 - DIGITIZE BOARD		198493	SUNGARD AVANTGARD LLC	0.00	0.00	450.00	0.00	
AP	02/10/2015	15328280	TRESSLER, DEBBIE - Brd mtg		1686	BMO MASTERCARD	0.00	0.00	20.87	0.00	
AP	02/10/2015	15328598	TRESSLER, DEBBIE - Office supplies		1686	BMO MASTERCARD	0.00	0.00	26.15	0.00	
AP	04/10/2015	15336889	TRESSLER, DEBBIE - Board mtg		1700	BMO MASTERCARD	0.00	0.00	29.47	0.00	
ACCOUNT SUMMARY				BUDG/BAL	ADJ. BUDGET	REQUISITION	ENCUMB	CURR DR/CR	YTD DR/CR	CURR BAL	PCT
100-70-4511-0000-4501				2,500.00	2,127.00	0.00	0.00	1,521.97	1,521.97	605.03	28.45
100-70-4511-0000-4503				100-70-SCH BOARD-GENL-SOFTWARE							
BA	03/25/2015	744	To purchase 2015 policy update				200.00	0.00	0.00	0.00	
AP	04/01/2015	15334624	16067 - Password to be issued		201404	ASSOCIATION OF ALASKA	0.00	0.00	1,095.00	0.00	
ACCOUNT SUMMARY				BUDG/BAL	ADJ. BUDGET	REQUISITION	ENCUMB	CURR DR/CR	YTD DR/CR	CURR BAL	PCT
100-70-4511-0000-4503				900.00	1,100.00	0.00	0.00	1,095.00	1,095.00	5.00	0.45
100-70-4511-0000-4850				100-70-SCH BOARD-GENL-STIPENDS							
JE	07/31/2014	15500112	PAYROLL - 07/31/2014				0.00	0.00	2,800.00	0.00	
JE	08/29/2014	15500824	PAYROLL - 08/29/2014				0.00	0.00	2,800.00	0.00	
JE	09/30/2014	15501770	PAYROLL - 09/30/2014				0.00	0.00	2,800.00	0.00	
JE	10/31/2014	15502803	PAYROLL - 10/31/2014				0.00	0.00	2,800.00	0.00	
JE	11/26/2014	15503627	PAYROLL - 11/26/2014				0.00	0.00	2,800.00	0.00	
JE	12/31/2014	15504356	PAYROLL - 12/31/2014				0.00	0.00	2,800.00	0.00	
JE	01/30/2015	15505186	PAYROLL - 01/30/2015				0.00	0.00	2,800.00	0.00	
JE	02/27/2015	15506079	PAYROLL - 02/27/2015				0.00	0.00	2,800.00	0.00	
JE	03/31/2015	15506915	PAYROLL - 03/31/2015				0.00	0.00	2,800.00	0.00	
ACCOUNT SUMMARY				BUDG/BAL	ADJ. BUDGET	REQUISITION	ENCUMB	CURR DR/CR	YTD DR/CR	CURR BAL	PCT
100-70-4511-0000-4850				33,600.00	33,600.00	0.00	0.00	25,200.00	25,200.00	8,400.00	25.00
100-70-4511-0000-4901				100-70-SCH BOARD-GENL-OTHER EXP							
AP	02/04/2015	15327157	185464 - 1/1/15-12/31/15		199290	NATIONAL SCHOOL BOARD	0.00	0.00	5,335.00	0.00	

General Info Pkt Page 35

## ACCOUNT ACTIVITY DETAILS REPORT

GLESLINE FOR BEGINNING BALANCE TO APRIL, 2015

11:06:42 AM | 04/28/2015

Process ID: 167493

ACCOUNT NO		ACCOUNT NAME			SHORT NAME					
TY	DATE	DOC NO	DESCRIPTION	PO NO	CHECK NO	PAYEE/PAYER NAME	BUD ADJ	ENCUMB	DEBIT	CREDIT
<b>Fund : OPERATING FUND [100]</b>										
<b>Location : BOARD OF EDUCATION [70]</b>										
AP	02/11/2015	15328071	15943 - Annual Membership Dues		199420	ASSOCIATION OF ALASKA	0.00	0.00	22,311.00	0.00
BA	03/25/2015	744	To purchase 2015 policy update				-200.00	0.00	0.00	0.00
<b>ACCOUNT SUMMARY</b>				<b>BUDG/BAL</b>	<b>ADJ. BUDGET</b>	<b>REQUISITION</b>	<b>ENCUMB</b>	<b>CURR DR/CR</b>	<b>YTD DR/CR</b>	<b>CURR BAL</b>
<b>100-70-4511-0000-4901</b>				<b>28,900.00</b>	<b>28,700.00</b>	<b>0.00</b>	<b>0.00</b>	<b>27,646.00</b>	<b>27,646.00</b>	<b>1,054.00</b>
<b>100-70-4511-0125-4201</b>				<b>100-70-SCH BOARD-LEGISLATIVE -MEALS</b>						
AP	02/25/2015	15329982	2/7-2/10/15 - TRAVEL - MEALS		200014	DOWNING, ELIZABETH	0.00	0.00	156.00	0.00
AP	04/08/2015	15336478	3/28-3/31/15 - TRAVEL - MEALS		201828	HILTS, EDITH-HELEN	0.00	0.00	158.00	0.00
AP	04/08/2015	15336480	3/28-3/31/15 - TRAVEL - MEALS		201726	BRETT-VADLA, KAREN	0.00	0.00	217.25	0.00
<b>ACCOUNT SUMMARY</b>				<b>BUDG/BAL</b>	<b>ADJ. BUDGET</b>	<b>REQUISITION</b>	<b>ENCUMB</b>	<b>CURR DR/CR</b>	<b>YTD DR/CR</b>	<b>CURR BAL</b>
<b>100-70-4511-0125-4201</b>				<b>1,000.00</b>	<b>1,000.00</b>	<b>0.00</b>	<b>0.00</b>	<b>531.25</b>	<b>531.25</b>	<b>468.75</b>
<b>100-70-4511-0125-4202</b>				<b>100-70-SCH BOARD-LEGISLATIVE -MILEAGE</b>						
AP	04/08/2015	15336480	3/28-3/31/15 - TRAVEL - MILEAGE		201726	BRETT-VADLA, KAREN	0.00	0.00	13.80	0.00
<b>ACCOUNT SUMMARY</b>				<b>BUDG/BAL</b>	<b>ADJ. BUDGET</b>	<b>REQUISITION</b>	<b>ENCUMB</b>	<b>CURR DR/CR</b>	<b>YTD DR/CR</b>	<b>CURR BAL</b>
<b>100-70-4511-0125-4202</b>				<b>1,000.00</b>	<b>1,000.00</b>	<b>0.00</b>	<b>0.00</b>	<b>13.80</b>	<b>13.80</b>	<b>986.20</b>
<b>100-70-4511-0125-4203</b>				<b>100-70-SCH BOARD-LEGISLATIVE -OTHR TRVL</b>						
AP	02/25/2015	15329655	16022 - Downing AASB		199961	ASSOCIATION OF ALASKA	0.00	0.00	435.00	0.00
AP	02/25/2015	15329655	16022 - Hohl AASB Registration		199961	ASSOCIATION OF ALASKA	0.00	0.00	435.00	0.00
CD	03/05/2015	15416639	REIMBURSE FOR LOWER TICKET				0.00	0.00	0.00	130.00
AP	03/13/2015	15331700	DOWNING, LIZ - Airfare AASB Fly-		1693	BMO MASTERCARD	0.00	0.00	532.70	0.00
AP	03/13/2015	15332226	DOWNING, LIZ - Ground transport		1693	BMO MASTERCARD	0.00	0.00	27.00	0.00
AP	03/13/2015	15332508	DOWNING, LIZ - Ground transport		1693	BMO MASTERCARD	0.00	0.00	32.20	0.00
BA	03/30/2015	764	To purchase board hotel, airfare,				-2,000.00	0.00	0.00	0.00
AP	04/08/2015	15336480	3/28-3/31/15 - TRAVEL - OTHER		201726	BRETT-VADLA, KAREN	0.00	0.00	470.70	0.00
AP	04/15/2015	15336544	16098 - Vadla registration fee		202026	ASSOCIATION OF ALASKA	0.00	0.00	435.00	0.00
AP	04/15/2015	15336544	16098 - Navarre registration fee		202026	ASSOCIATION OF ALASKA	0.00	0.00	435.00	0.00
<b>ACCOUNT SUMMARY</b>				<b>BUDG/BAL</b>	<b>ADJ. BUDGET</b>	<b>REQUISITION</b>	<b>ENCUMB</b>	<b>CURR DR/CR</b>	<b>YTD DR/CR</b>	<b>CURR BAL</b>
<b>100-70-4511-0125-4203</b>				<b>12,000.00</b>	<b>10,000.00</b>	<b>0.00</b>	<b>0.00</b>	<b>2,672.60</b>	<b>2,672.60</b>	<b>7,327.40</b>
<b>100-70-4511-0126-4201</b>				<b>100-70-SCH BOARD-PROFESSIOAL -MEALS</b>						
AP	11/19/2014	15317227	11/6-11/9/14 - TRAVEL - MEALS		196467	HILTS, EDITH-HELEN	0.00	0.00	67.00	0.00
AP	11/26/2014	15317592	11/6-11/9/14 - TRAVEL - MEALS		196685	BRETT-VADLA, KAREN	0.00	0.00	97.00	0.00
AP	12/03/2014	15318845	11/6-11/9/14 - TRAVEL - MEALS		196919	CASTIMORE, DANIEL	0.00	0.00	180.00	0.00
AP	12/10/2014	15319524	11/9-11/9/14 - TRAVEL - MEALS		197247	DOWNING, ELIZABETH	0.00	0.00	64.00	0.00
AP	12/31/2014	15322383	11/6-9/14ME - TRAVEL - MEALS		197980	KULIKOV, AKCINIA	0.00	0.00	64.00	0.00
AP	01/07/2015	15323552	12/12-12/13/14 - TRAVEL - MEALS		198067	CASTIMORE, DANIEL	0.00	0.00	128.00	0.00
AP	04/08/2015	15336487	3/21-3/24/15 - TRAVEL - MEALS		201828	HILTS, EDITH-HELEN	0.00	0.00	156.00	0.00
<b>ACCOUNT SUMMARY</b>				<b>BUDG/BAL</b>	<b>ADJ. BUDGET</b>	<b>REQUISITION</b>	<b>ENCUMB</b>	<b>CURR DR/CR</b>	<b>YTD DR/CR</b>	<b>CURR BAL</b>
<b>100-70-4511-0126-4201</b>				<b>1,000.00</b>	<b>1,000.00</b>	<b>0.00</b>	<b>0.00</b>	<b>756.00</b>	<b>756.00</b>	<b>244.00</b>
<b>100-70-4511-0126-4202</b>				<b>100-70-SCH BOARD-PROFESSIOAL -MILEAGE</b>						
AP	11/26/2014	15317592	11/6-11/9/14 - TRAVEL - MILEAGE		196685	BRETT-VADLA, KAREN	0.00	0.00	168.00	0.00
AP	12/10/2014	15319524	11/9-11/9/14 - TRAVEL - MILEAGE		197247	DOWNING, ELIZABETH	0.00	0.00	208.88	0.00
AP	12/31/2014	15322384	11/6-9/14MI - TRAVEL - MILEAGE		197980	KULIKOV, AKCINIA	0.00	0.00	190.40	0.00

## ACCOUNT ACTIVITY DETAILS REPORT

GLESLINE FOR BEGINNING BALANCE TO APRIL, 2015

11:06:42 AM | 04/28/2015

Process ID: 167493

ACCOUNT NO		ACCOUNT NAME		SHORT NAME						
TY	DATE	DOC NO	DESCRIPTION	PO NO	CHECK NO	PAYEE/PAYER NAME	BUD ADJ	ENCUMB	DEBIT	CREDIT
<b>Fund : OPERATING FUND [100]</b>										
<b>Location : BOARD OF EDUCATION [70]</b>										
AP	01/07/2015	15323552	12/12-12/13/14 - TRAVEL -		198067	CASTIMORE, DANIEL	0.00	0.00	168.00	0.00
<b>ACCOUNT SUMMARY</b>				<b>BUDG/BAL</b>	<b>ADJ. BUDGET</b>	<b>REQUISITION</b>	<b>ENCUMB</b>	<b>CURR DR/CR</b>	<b>YTD DR/CR</b>	<b>CURR BAL</b>
<b>100-70-4511-0126-4202</b>				<b>1,000.00</b>	<b>1,000.00</b>	<b>0.00</b>	<b>0.00</b>	<b>735.28</b>	<b>735.28</b>	<b>264.72</b>
<b>100-70-4511-0126-4203</b>				<b>100-70-SCH BOARD-PROFESSIOAL -OTHR TRVL</b>						
AP	11/12/2014	15316630	3/21-3/23/15 - TRAVEL - OTHER		196158	HOHL, LYNN	0.00	0.00	725.00	0.00
AP	11/19/2014	15317227	11/6-11/9/14 - TRAVEL - OTHER		196467	HILTS, EDITH HELEN	0.00	0.00	223.00	0.00
AP	12/10/2014	15319397	15854 - DOWNING		197198	ASSOCIATION OF ALASKA	0.00	0.00	490.00	0.00
AP	12/10/2014	15319397	15854 - HILTS		197198	ASSOCIATION OF ALASKA	0.00	0.00	490.00	0.00
AP	12/10/2014	15319397	15854 - HOHL		197198	ASSOCIATION OF ALASKA	0.00	0.00	490.00	0.00
AP	12/10/2014	15319397	15854 - VADLA		197198	ASSOCIATION OF ALASKA	0.00	0.00	490.00	0.00
AP	12/10/2014	15319397	15854 - CASTIMORE		197198	ASSOCIATION OF ALASKA	0.00	0.00	490.00	0.00
AP	12/10/2014	15319406	REIMBURSEMENT - NSBA AIRFARE		197284	HILTS, EDITH HELEN	0.00	0.00	673.60	0.00
AP	12/10/2014	15319524	11/9-11/9/14 - TRAVEL - OTHER		197247	DOWNING, ELIZABETH	0.00	0.00	24.00	0.00
AP	12/11/2014	15320182	TRESSLER, DEBBIE - Airfare AASB -		1670	BMO MASTERCARD	0.00	0.00	170.00	0.00
AP	12/11/2014	15320772	HILTS, EDITH HELEN - Registration		1670	BMO MASTERCARD	0.00	0.00	725.00	0.00
AP	12/11/2014	15320897	CASTIMORE, DANIEL - Cab AASB		1670	BMO MASTERCARD	0.00	0.00	24.50	0.00
AP	12/11/2014	15321007	DOWNING, LIZ - Hotel AASB-		1670	BMO MASTERCARD	0.00	0.00	458.56	0.00
AP	12/11/2014	15321008	HILTS, EDITH HELEN - Hotel AASB		1670	BMO MASTERCARD	0.00	0.00	434.56	0.00
AP	12/11/2014	15321044	HOHL, LYNN - Hotel AASB Mtg-		1670	BMO MASTERCARD	0.00	0.00	363.00	0.00
AP	12/11/2014	15321082	CASTIMORE, DANIEL - Hotel AASB-		1670	BMO MASTERCARD	0.00	0.00	291.00	0.00
AP	12/11/2014	15321094	VADLA, PENNY - Hotel-AASB-		1670	BMO MASTERCARD	0.00	0.00	456.00	0.00
AP	12/17/2014	15321901	15882 - Castimore registration-		197450	ASSOCIATION OF ALASKA	0.00	0.00	375.00	0.00
AP	12/31/2014	15322385	11/6-9/14 - TRAVEL - OTHER		197980	KULIKOV, AKCINIA	0.00	0.00	96.00	0.00
AP	01/07/2015	15323552	12/12-12/13/14 - TRAVEL - OTHER		198067	CASTIMORE, DANIEL	0.00	0.00	20.00	0.00
AP	01/09/2015	15324927	CASTIMORE, DANIEL - Hotel AASB		1678	BMO MASTERCARD	0.00	0.00	212.80	0.00
AP	02/10/2015	15328491	CASTIMORE, DANIEL - Hotel tax		1686	BMO MASTERCARD	0.00	0.00	-22.80	0.00
AP	02/10/2015	15328717	DOWNING, LIZ - Hotel tax refund		1686	BMO MASTERCARD	0.00	0.00	-46.56	0.00
AP	02/10/2015	15328718	HILTS, EDITH HELEN - Hotel tax		1686	BMO MASTERCARD	0.00	0.00	-46.56	0.00
BA	03/30/2015	763	To purchase regular board				-500.00	0.00	0.00	0.00
AP	04/10/2015	15337060	NAVARRE, TIM - Airfare-AASB fly-		1700	BMO MASTERCARD	0.00	0.00	600.70	0.00
AP	04/10/2015	15337594	HILTS, EDITH HELEN - Hotel for		1700	BMO MASTERCARD	0.00	0.00	95.20	0.00
<b>ACCOUNT SUMMARY</b>				<b>BUDG/BAL</b>	<b>ADJ. BUDGET</b>	<b>REQUISITION</b>	<b>ENCUMB</b>	<b>CURR DR/CR</b>	<b>YTD DR/CR</b>	<b>CURR BAL</b>
<b>100-70-4511-0126-4203</b>				<b>12,000.00</b>	<b>11,500.00</b>	<b>0.00</b>	<b>0.00</b>	<b>8,302.00</b>	<b>8,302.00</b>	<b>3,198.00</b>
<b>** Location : BOARD OF EDUCATION [70] TOTAL **</b>				<b>BUDG/BAL</b>	<b>ADJ. BUDGET</b>	<b>REQUISITION</b>	<b>ENCUMB</b>	<b>CURR DR/CR</b>	<b>YTD DR/CR</b>	<b>CURR BAL</b>
				<b>337,246.00</b>	<b>338,994.00</b>	<b>0.00</b>	<b>18,125.43</b>	<b>278,214.95</b>	<b>278,214.95</b>	<b>42,653.62</b>
<b>** Fund : OPERATING FUND [100] TOTAL **</b>				<b>BUDG/BAL</b>	<b>ADJ. BUDGET</b>	<b>REQUISITION</b>	<b>ENCUMB</b>	<b>CURR DR/CR</b>	<b>YTD DR/CR</b>	<b>CURR BAL</b>
				<b>337,246.00</b>	<b>338,994.00</b>	<b>0.00</b>	<b>18,125.43</b>	<b>278,214.95</b>	<b>278,214.95</b>	<b>42,653.62</b>
<b>** GRAND TOTAL **</b>				<b>BUDG/BAL</b>	<b>ADJ. BUDGET</b>	<b>REQUISITION</b>	<b>ENCUMB</b>	<b>CURR DR/CR</b>	<b>YTD DR/CR</b>	<b>CURR BAL</b>
				<b>337,246.00</b>	<b>338,994.00</b>	<b>0.00</b>	<b>18,125.43</b>	<b>278,214.95</b>	<b>278,214.95</b>	<b>42,653.62</b>

# ACCOUNT ACTIVITY DETAILS REPORT

GLEXLIN FOR BEGINNING BALANCE TO APRIL, 2015

---

## REPORT CRITERIA

---

Process Name	: Account Activity Details Report
Criteria Name	: GLEXLIN LOC 70
Report Title	: GLEXLIN
Responsibility Group	: -
Document Types	: -
Period From	: Beginning Balance
Period To	: April, 2015
Account Element Filters	: 1 - 1 - Fund - from: 100 - to: 100,8 - 8 - Location - from: 70 - to: 70,3 - 3 - Function - from: 0000 - to: 9999,10 - 10 - Program - from: 0000 - to: 9999,5 - 5 - Object - from: 3000 - to: 9999
Account Grouping	: 1 - Fund - All,8 - Location - All
Page Break	: -
Additional Account Sorting	: -
Show Audit Entries	: Yes
Skip Grouping By Account	: No
Employee Salary Details	: No
Employee Benefit Details	: No

## 2014-2015 Board Travel Report

Month	Routine Travel	Board Meals	Lobbying	Professional Development	Total All Categories
<b>July</b>	\$197.12	\$396.00			
<b>August</b>	\$760.92				
<b>September</b>	\$1,726.84	\$881.91			
<b>October</b>	\$1,040.10	\$303.91			
<b>November</b>	\$564.48	\$299.00			
Hilts-AASB Annual-Meals, hotel, travel				\$290.00	
Hohl-NSBA fee				\$725.00	
Vadla-AASB Annual-Meals, mileage				\$265.00	
<b>December</b>	\$2,627.32	\$542.47			
Castimore-AASB & Annual Brdmanship				\$1,530.50	
Downing-AASB Annual				\$1,245.44	
Hilts-AASB Annual, NSBA air/reg				\$2,323.16	
Hohl-AASB Annual				\$853.00	
Kulikov-YLI				\$350.40	
Vadla-AASB Annual				\$946.00	
<b>January</b>	\$1,215.65	\$248.00			
Castimore-Brdmnshp expenses				\$528.80	
<b>February</b>	\$1,636.21	\$416.50			
Downing Fly-In Miles, Registration			\$591.00		
Hohl Fly-In Registration			\$435.00		
AASB Conf. Hotel tax refunds				-\$115.92	
<b>March</b>	\$4,635.67	\$483.75			
Downing-AASB Fly-In transportation			\$591.90		
Hohl/Downing-AASB Fly-in Hotel			\$980.00		
Navarre-AASB Fly-In airfare reimbursement			-\$130.00		
<b>April</b>	\$1,524.63	\$353.75			
Hilts AASB Fly-In Meals			\$158.00		
Vadla AASB Fly-In expenses			\$1,136.75		
Navarre AASB Fly-In Reg., airfare			\$1,035.70		
Hilts NSBA meals, hotel				\$251.20	

## 2014-2015 Board Travel Report

Month	Routine Travel	Board Meals	Lobbying	Professional Development	Total All Categories
<b>Total</b>	<b>\$15,928.94</b>	<b>\$3,925.29</b>	<b>\$4,798.35</b>	<b>\$9,192.58</b>	<b>\$33,845.16</b>





## KENAI PENINSULA BOROUGH SCHOOL DISTRICT

148 North Binkley Street Soldotna, Alaska 99669-7520

Phone (907) 714-8888 Fax (907) 262-9132

[www.kpbsd.k12.ak.us](http://www.kpbsd.k12.ak.us)

### SCHOOL BOARD COMMUNICATION

**Title:** Early Release Survey Results

**Date:**

**Item Number:**

General  
Information

**Administrator:** Sean Dusek *Sean Dusek*  
Superintendent of Schools

**Attachments:** Survey results

☐ Action Needed   ☐ For Discussion   ☒ Information   ☐ Other: \_\_\_\_\_

### BACKGROUND INFORMATION

We recently conducted a survey of parents and staff regarding our early release days. Based on the results of the survey, I will be bringing forward the 2015-16 dates for your approval at the June 1 board meeting.

### ADMINISTRATIVE RECOMMENDATION

**Q1 Which school does your child currently attend? \*If you have children attending multiple KPBSD schools, please indicate each school your children attend.**

Answered: 528 Skipped: 0

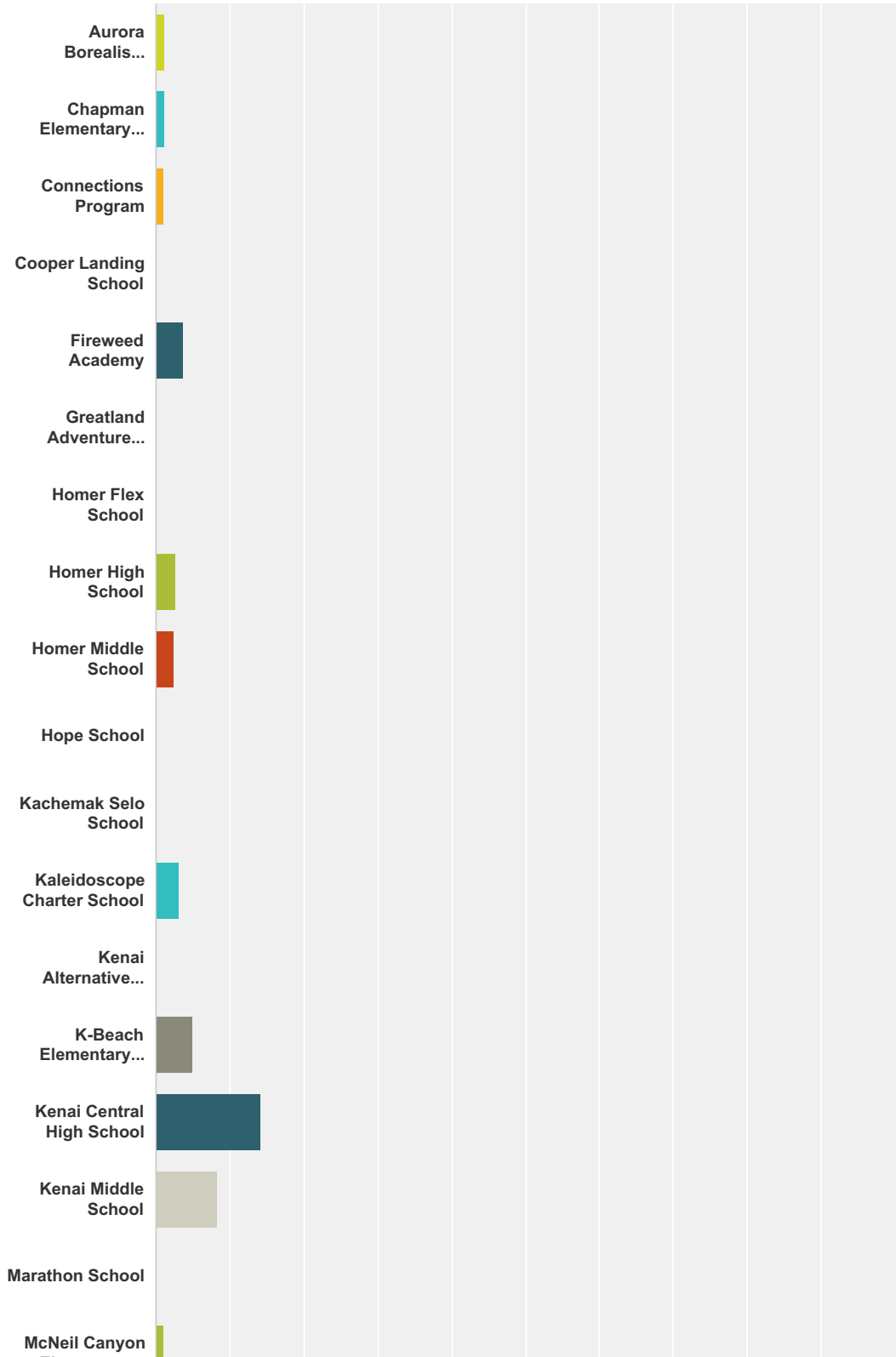

KPBSD Parent Survey: Student Early Release and Teacher Collaboration in FY15

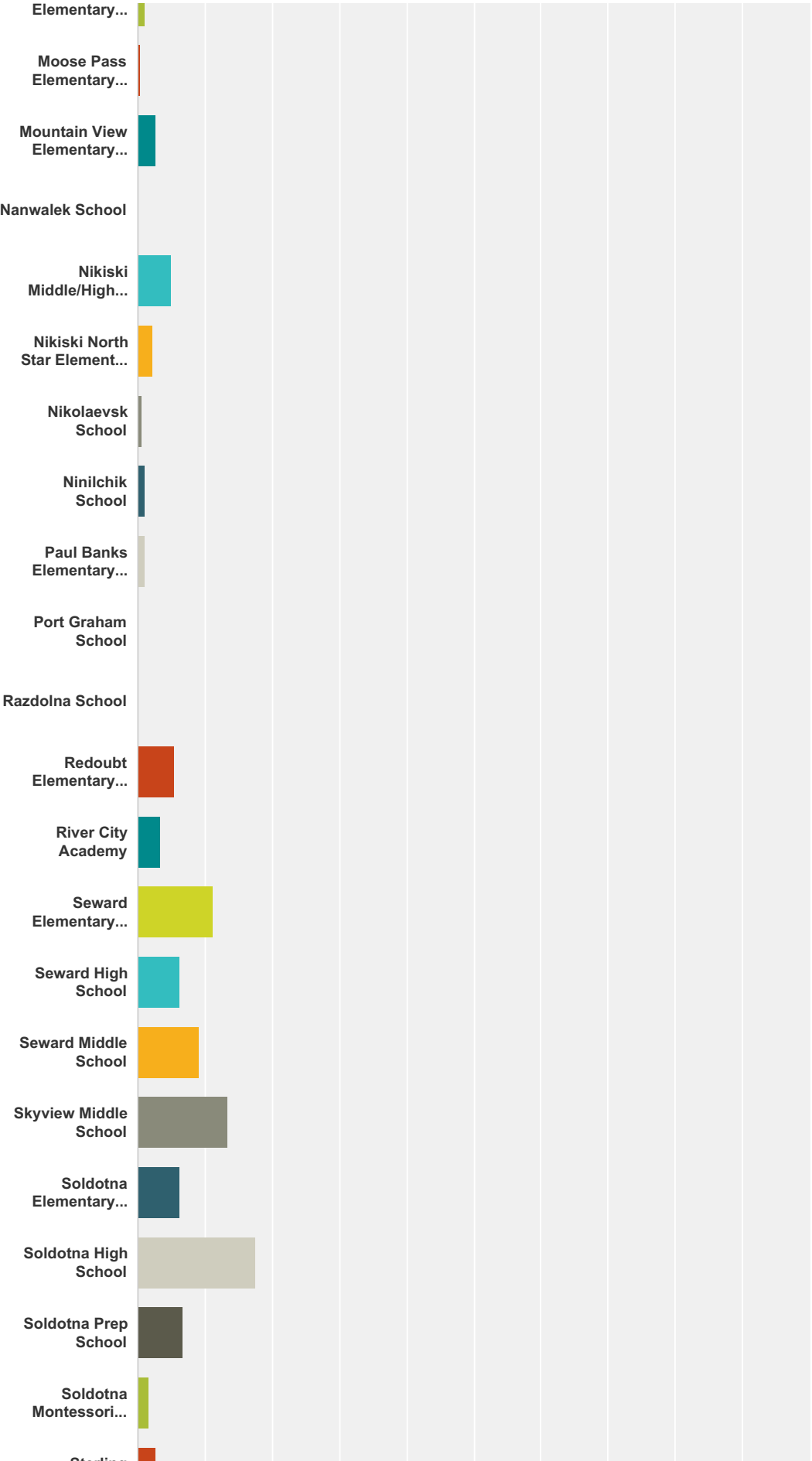

# KPBSD Parent Survey: Student Early Release and Teacher Collaboration in FY15

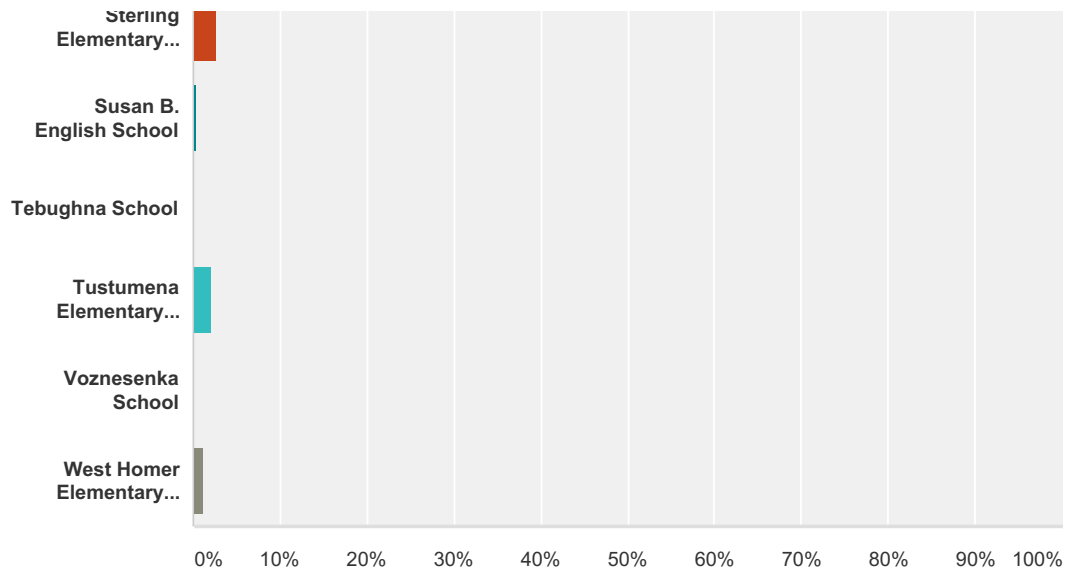

Answer Choices	Responses
Aurora Borealis Charter School	1.33% 7
Chapman Elementary School	1.33% 7
Connections Program	0.95% 5
Cooper Landing School	0.19% 1
Fireweed Academy	3.79% 20
Greatland Adventure Academy	0.19% 1
Homer Flex School	0.19% 1
Homer High School	2.65% 14
Homer Middle School	2.46% 13
Hope School	0.00% 0
Kachemak Selo School	0.00% 0
Kaleidoscope Charter School	3.22% 17
Kenai Alternative School	0.00% 0
K-Beach Elementary School	5.11% 27
Kenai Central High School	14.20% 75
Kenai Middle School	8.33% 44
Marathon School	0.00% 0
McNeil Canyon Elementary School	1.14% 6
Moose Pass Elementary School	0.38% 2
Mountain View Elementary School	2.65% 14

## KPBSD Parent Survey: Student Early Release and Teacher Collaboration in FY15

Nanwalek School	0.00%	0
Nikiski Middle/High School	4.92%	26
Nikiski North Star Elementary School	2.27%	12
Nikolaevsk School	0.57%	3
Ninilchik School	1.14%	6
Paul Banks Elementary School	1.14%	6
Port Graham School	0.00%	0
Razdolna School	0.00%	0
Redoubt Elementary School	5.49%	29
River City Academy	3.41%	18
Seward Elementary School	11.17%	59
Seward High School	6.25%	33
Seward Middle School	9.09%	48
Skyview Middle School	13.26%	70
Soldotna Elementary School	6.25%	33
Soldotna High School	17.61%	93
Soldotna Prep School	6.63%	35
Soldotna Montessori Charter School	1.70%	9
Sterling Elementary School	2.65%	14
Susan B. English School	0.38%	2
Tebughna School	0.19%	1
Tustumena Elementary School	2.08%	11
Voznesenka School	0.00%	0
West Homer Elementary School	1.33%	7
<b>Total Respondents: 528</b>		

**Q2 The school district plans to continue a minimum day for students up to seven times in the 2015-2016 school year, in order to give certified staff collaboration time to better meet the learning needs of our students. Do you believe the effect of the early release time for students is beneficial for our teachers?**

Answered: 487 Skipped: 41

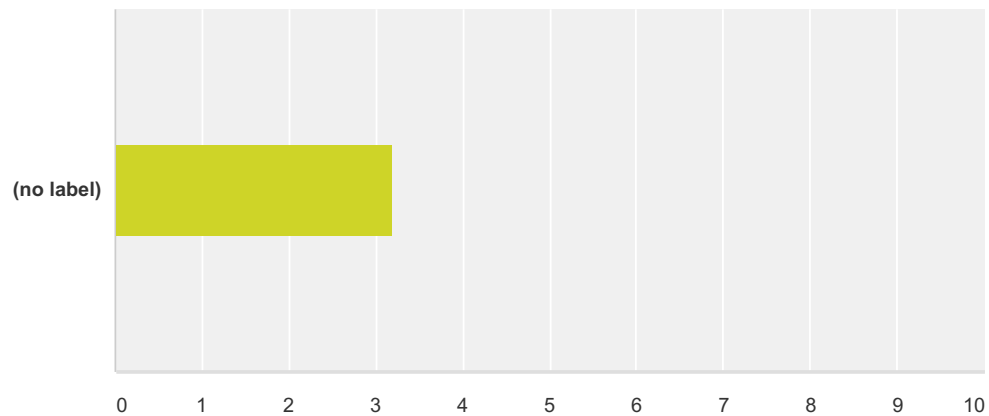

	Definitely beneficial - makes a difference	(no label)	Beneficial	(no label)	Not beneficial	I do not have an opinion	Total	Weighted Average
(no label)	26.49% 129	17.86% 87	30.39% 148	8.21% 40	8.62% 42	8.42% 41	487	3.20

**Q3 The school district plans to continue a minimum day for students up to seven times in the 2015-2016 school year, in order to give certified staff collaboration time to better meet the learning needs of our students. Do you believe the effect of the early release time for students is beneficial to your child or children?**

Answered: 487 Skipped: 41

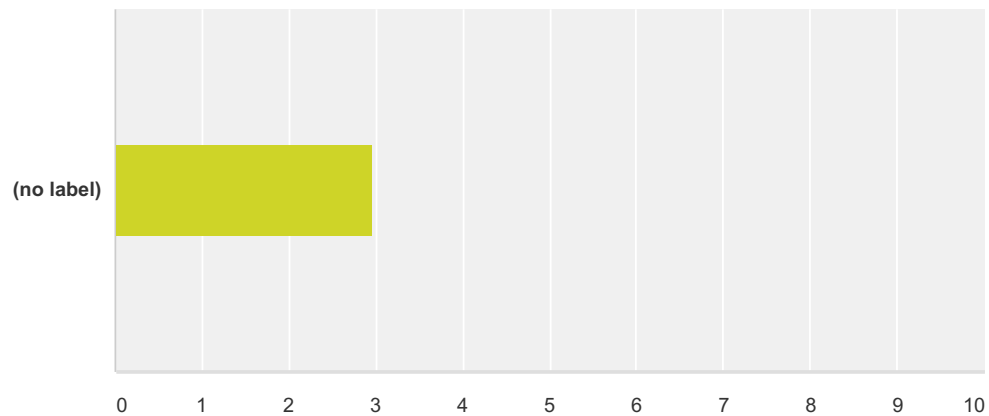

	Definitely beneficial - makes a difference	(no label)	Beneficial	(no label)	Not beneficial	I do not have an opinion	Total	Weighted Average
(no label)	21.97% 107	16.22% 79	28.54% 139	8.01% 39	19.30% 94	5.95% 29	487	2.96

**Q4 What is your preference for up to seven early release days during the 2015-2016 school year? \*Student day ends 90 minutes earlier than a normal school day schedule**

Answered: 487 Skipped: 41

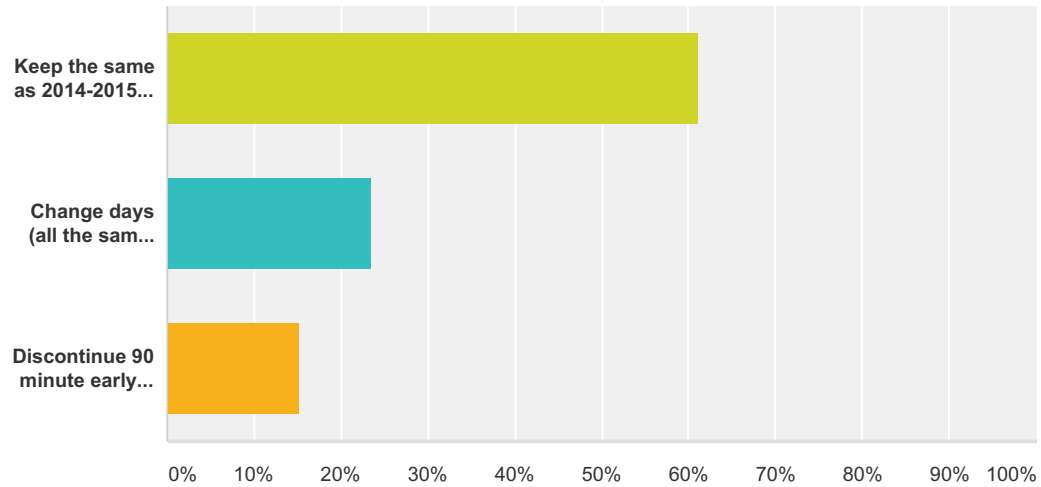

Answer Choices	Responses	
Keep the same as 2014-2015 (mix of Wednesday and Friday afternoons)	61.19%	298
Change days (all the same, or indicate new idea with a comment)	23.61%	115
Discontinue 90 minute early release days for students	15.20%	74
<b>Total</b>		<b>487</b>



## Q1 Where in the KPBSD do you work?

Answered: 307 Skipped: 0

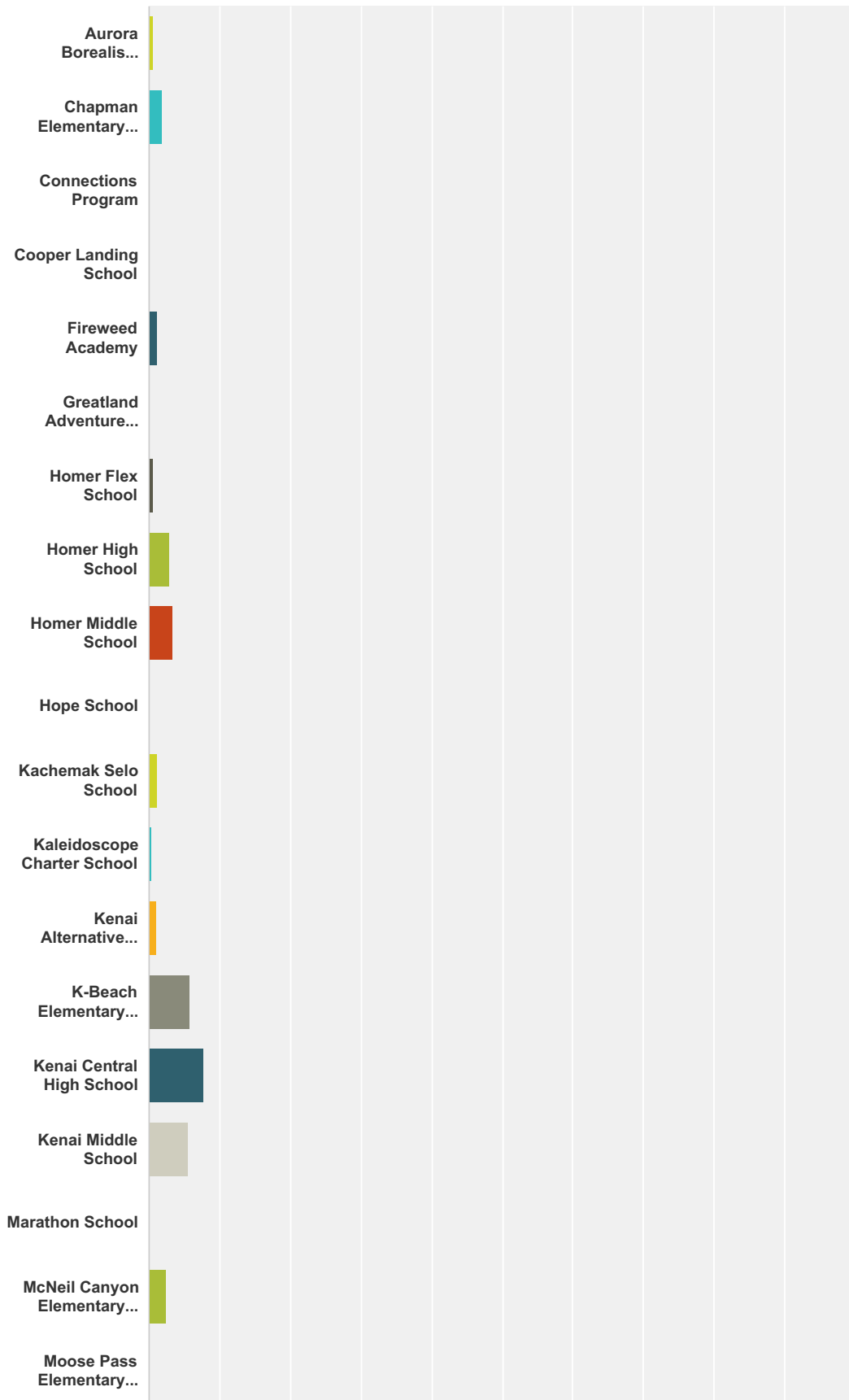

# KPBSD Staff Survey: Collaboration Effectiveness on Early Release Days in FY15

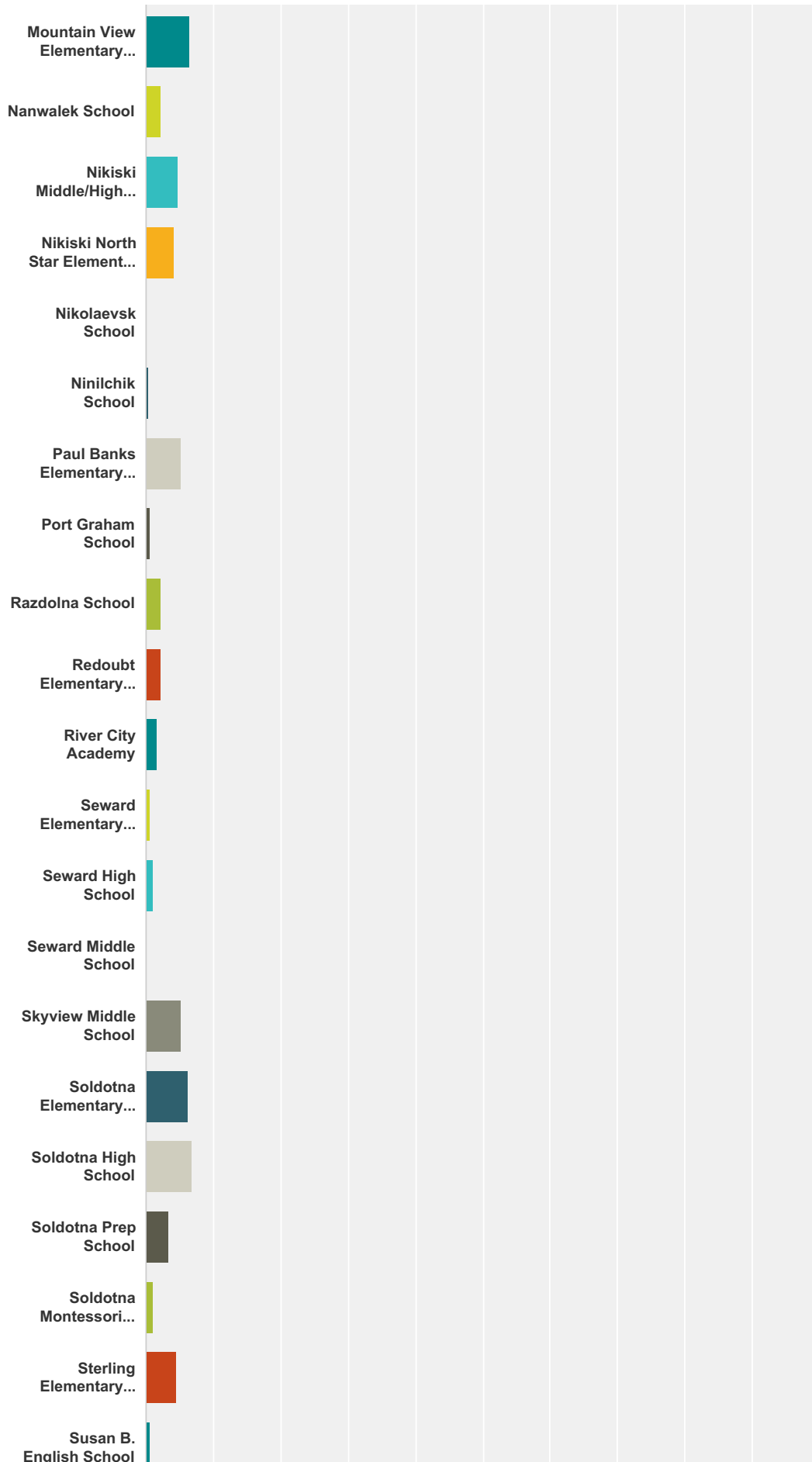

## KPBSD Staff Survey: Collaboration Effectiveness on Early Release Days in FY15

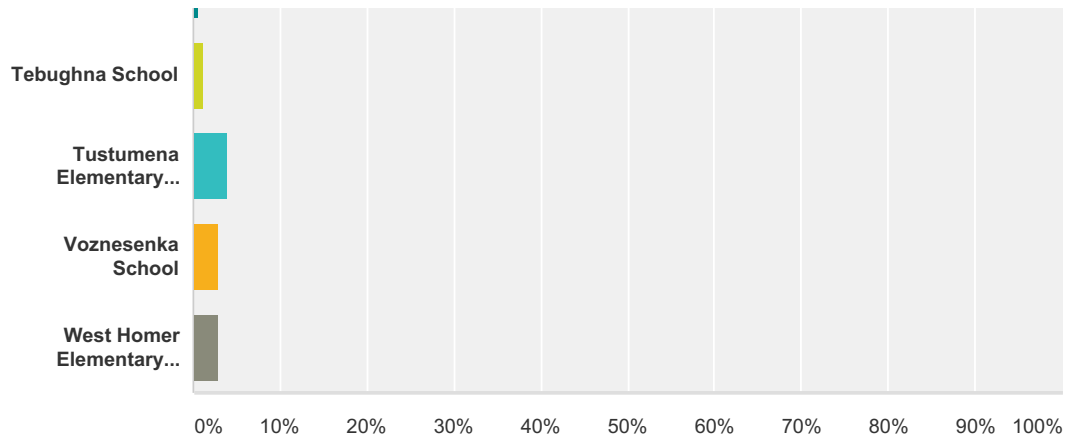

Answer Choices	Responses
Aurora Borealis Charter School	0.65% 2
Chapman Elementary School	1.95% 6
Connections Program	0.00% 0
Cooper Landing School	0.00% 0
Fireweed Academy	1.30% 4
Greatland Adventure Academy	0.00% 0
Homer Flex School	0.65% 2
Homer High School	2.93% 9
Homer Middle School	3.26% 10
Hope School	0.00% 0
Kachemak Selo School	1.30% 4
Kaleidoscope Charter School	0.33% 1
Kenai Alternative School	0.98% 3
K-Beach Elementary School	5.86% 18
Kenai Central High School	7.82% 24
Kenai Middle School	5.54% 17
Marathon School	0.00% 0
McNeil Canyon Elementary School	2.61% 8
Moose Pass Elementary School	0.00% 0
Mountain View Elementary School	6.51% 20
Nanwalek School	2.28% 7
Nikiski Middle/High School	4.89% 15

## KPBSD Staff Survey: Collaboration Effectiveness on Early Release Days in FY15

Nikiski North Star Elementary School	4.23%	13
Nikolaevsk School	0.00%	0
Ninilchik School	0.33%	1
Paul Banks Elementary School	5.21%	16
Port Graham School	0.65%	2
Razdolna School	2.28%	7
Redoubt Elementary School	2.28%	7
River City Academy	1.63%	5
Seward Elementary School	0.65%	2
Seward High School	0.98%	3
Seward Middle School	0.00%	0
Skyview Middle School	5.21%	16
Soldotna Elementary School	6.19%	19
Soldotna High School	6.84%	21
Soldotna Prep School	3.26%	10
Soldotna Montessori Charter School	0.98%	3
Sterling Elementary School	4.56%	14
Susan B. English School	0.65%	2
Tebughna School	1.30%	4
Tustumena Elementary School	3.91%	12
Voznesenka School	2.93%	9
West Homer Elementary School	2.93%	9
<b>Total Respondents: 307</b>		

**Q2 Has the extra collaboration time, created by the six minimum student days, effectively impacted your instruction?**

Answered: 294 Skipped: 13

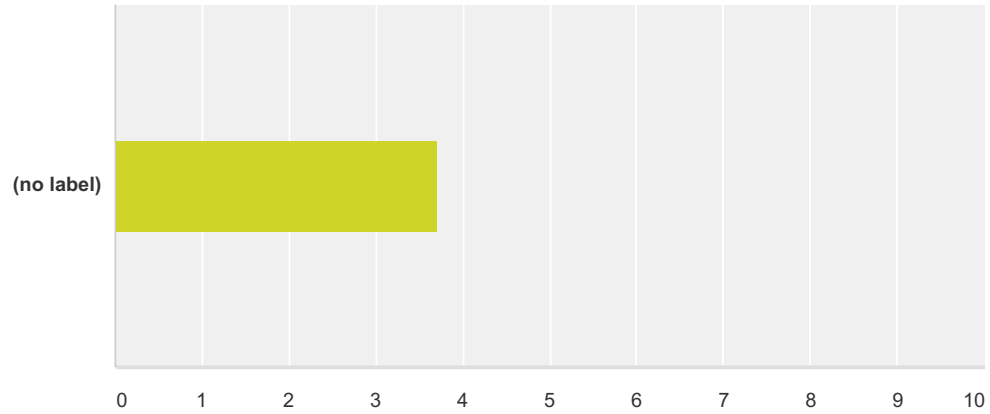

	Not helpful	Marginal effectiveness	Somewhat effective	Effective	Highly effective	Total	Weighted Average
(no label)	4.42% 13	8.84% 26	20.07% 59	44.22% 130	22.45% 66	294	3.71

**Q3 Has the extra collaboration time, created by the six minimum student days, impacted your students in a positive way?**

Answered: 294 Skipped: 13

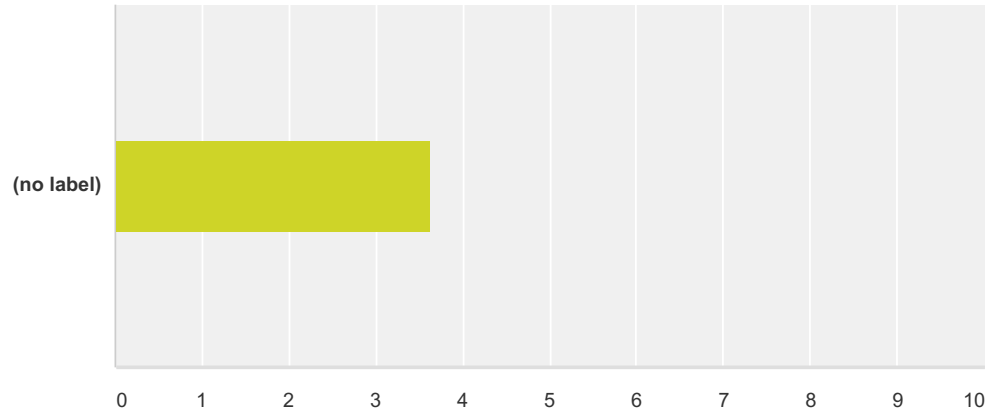

	Not helpful	Marginal effectiveness	Somewhat effective	Effective	Highly effective	Total	Weighted Average
(no label)	5.44% 16	9.86% 29	19.39% 57	46.60% 137	18.71% 55	294	3.63

**Q4 What is your preference for up to seven early release days during the 2015-2016 school year? \*Student day ends 90 minutes earlier than a normal school day schedule**

Answered: 294 Skipped: 13

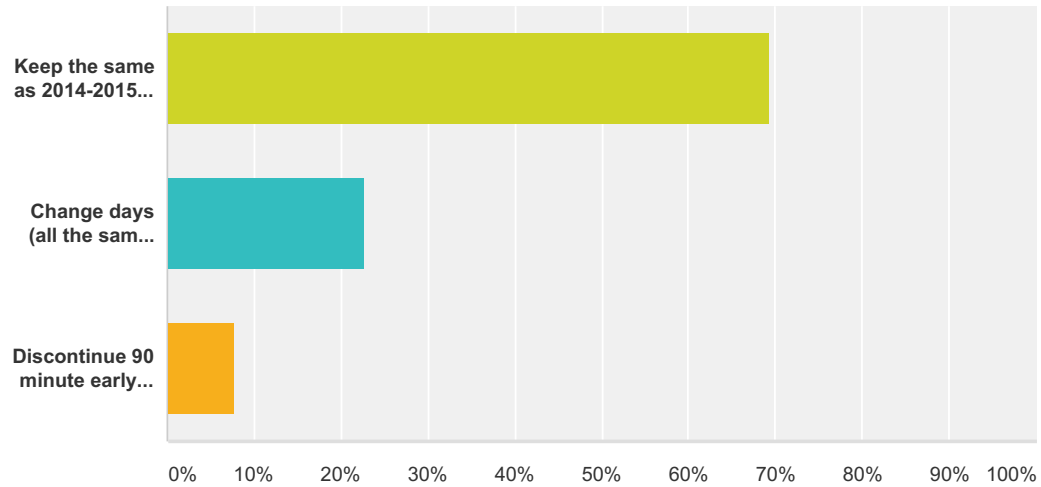

Answer Choices	Responses	
Keep the same as 2014-2015 (mix of Wednesday and Friday afternoons)	69.39%	204
Change days (all the same, or indicate new idea with a comment)	22.79%	67
Discontinue 90 minute early release days for students	7.82%	23
<b>Total</b>		<b>294</b>

KENAI PENINSULA BOROUGH SCHOOL DISTRICT																			
2014 - 2015 SCHOOL YEAR																			
Tuesday, April 28, 2015																			
ADM PROJECTED ENROLLMENT	TOTAL ADM	ADM DIFF +/-	ADM DIFF %	SCHOOLS	KDGN	1ST	2ND	3RD	4TH	5TH	6TH	7TH	8TH	9TH	10TH	11TH	12TH	Enrollment Total	Inc. P/S Enrollment Total
185.00	183.00	-2.00	(1%)	Aurora Borealis Charter	25	21	24	21	20	23	19	13	17	0	0	0	0	183	184
117.00	113.00	-4.00	(3%)	Chapman	17	16	16	14	11	7	11	6	15	0	0	0	0	113	124
760.00	772.00	12.00	2%	Connections Program	55	43	48	45	47	42	41	57	53	57	79	104	101	772	772
21.00	13.00	-8.00	(38%)	Cooper Landing	4	1	0	2	3	0	2	0	1	0	0	0	0	13	13
116.00	94.00	-22.00	(19%)	Fireweed Academy	9	24	12	16	9	9	15	0	0	0	0	0	0	94	94
36.00	25.00	-11.00	(31%)	Homer Flex	0	0	0	0	0	0	0	0	0	6	10	6	3	25	25
385.00	351.00	-34.00	(9%)	Homer High	0	0	0	0	0	0	0	0	0	95	83	81	92	351	351
180.00	191.00	11.00	6%	Homer Middle	0	0	0	0	0	0	0	93	98	0	0	0	0	191	191
18.00	21.00	3.00	17%	Hope Elementary/High	2	1	3	2	3	3	2	1	2	0	1	0	1	21	21
383.00	379.00	-4.00	(1%)	K-Beach Elementary	59	62	52	52	54	62	38	0	0	0	0	0	0	379	387
60.00	56.00	-4.00	(7%)	Kachemak Selo	2	4	2	5	6	6	7	3	8	6	3	3	1	56	56
252.00	252.00	0.00	0%	Kaleidoscope Charter	39	39	41	38	44	40	11	0	0	0	0	0	0	252	252
78.00	50.00	-28.00	(36%)	Kenai Alternative	0	0	0	0	0	0	0	0	0	0	7	26	17	50	63
526.00	458.00	-68.00	(13%)	Kenai Central High	0	0	0	0	0	0	0	0	0	114	129	105	110	458	458
353.00	375.00	22.00	6%	Kenai Middle	0	0	0	0	0	0	116	124	135	0	0	0	0	375	375
10.00	7.00	-3.00	(30%)	Marathon	0	0	0	0	0	0	0	0	0	5	1	1	0	7	7
136.00	122.00	-14.00	(10%)	McNeil Canyon Elementary	12	12	16	20	14	22	26	0	0	0	0	0	0	122	122
18.00	10.00	-8.00	(44%)	Moose Pass Elementary	3	2	0	2	2	1	0	0	0	0	0	0	0	10	10
415.00	418.00	3.00	1%	Mountain View Elementary	71	80	70	56	75	66	0	0	0	0	0	0	0	418	443
80.00	80.00	0.00	0%	Nanwalek Elementary/High	6	4	7	11	11	8	6	7	4	5	3	4	4	80	80
415.00	380.00	-35.00	(8%)	Nikiski Middle/High	0	0	0	0	0	0	55	52	58	49	62	54	50	380	380
339.00	349.00	10.00	3%	Nikiski North Star Elementary	72	55	60	60	51	51	0	0	0	0	0	0	0	349	372
71.00	66.00	-5.00	(7%)	Nikolaevsk Elem/High	2	2	2	5	2	10	8	10	2	9	3	8	3	66	67
142.00	138.00	-4.00	(3%)	Ninilchik Elementary/High	4	13	7	8	11	17	10	11	12	11	13	13	8	138	138
161.00	178.00	17.00	11%	Paul Banks Elementary	74	55	49	0	0	0	0	0	0	0	0	0	0	178	210
20.00	28.00	8.00	40%	Port Graham	3	5	3	2	4	2	2	1	1	2	2	0	1	28	28
83.00	82.00	-1.00	(1%)	Razdolna	7	4	13	4	9	10	8	5	9	1	4	4	4	82	82
372.00	400.00	28.00	8%	Redoubt Elementary	41	52	52	55	62	64	74	0	0	0	0	0	0	400	420
75.00	79.00	4.00	5%	River City Academy	0	0	0	0	0	0	0	9	22	9	15	10	14	79	79
282.00	282.00	0.00	0%	Seward Elementary	49	50	61	46	31	45	0	0	0	0	0	0	0	282	310
182.00	184.00	2.00	1%	Seward High	0	0	0	0	0	0	0	0	0	48	40	45	51	184	184
118.00	134.00	16.00	14%	Seward Middle	0	0	0	0	0	0	51	42	41	0	0	0	0	134	134
380.00	392.00	12.00	3%	Skyview Middle	0	0	0	0	0	0	0	205	187	0	0	0	0	392	392
269.00	300.00	31.00	12%	Soldotna Elementary	54	42	41	49	41	37	36	0	0	0	0	0	0	300	350
587.00	541.00	-46.00	(8%)	Soldotna High	0	0	0	0	0	0	0	0	0	0	195	166	180	541	541
165.00	151.00	-14.00	(8%)	Soldotna Montessori Charter	20	21	22	20	21	22	25	0	0	0	0	0	0	151	151
191.00	190.00	-1.00	(1%)	Soldotna Prep	0	0	0	0	0	0	0	0	0	0	190	0	0	190	190
200.00	230.00	30.00	15%	Sterling Elementary	30	30	46	36	28	30	30	0	0	0	0	0	0	230	240
47.00	45.00	-2.00	(4%)	Susan B. English	3	4	1	2	3	2	3	5	2	5	3	10	2	45	45
36.00	32.00	-4.00	(11%)	Tebughna Elementary/High	2	5	3	1	4	2	3	4	2	1	3	1	1	32	32
177.00	169.00	-8.00	(5%)	Tustumena Elementary	31	25	24	25	18	19	27	0	0	0	0	0	0	169	180
105.00	109.00	4.00	4%	Voznesenka	6	13	5	11	4	10	4	7	11	11	8	11	8	109	115
227.00	239.00	12.00	5%	West Homer Elementary	0	0	0	63	60	62	54	0	0	0	0	0	0	239	239
8,773	8,668.00	-105.00	(1%)		702	685	680	671	648	672	684	655	680	624	664	652	651	8,668	8,907



KENAI PENINSULA BOROUGH SCHOOL DISTRICT																		
2014 - 2015 SCHOOL YEAR																		
PART TIME STUDENTS																		
Tuesday, April 28, 2015																		
		SCHOOLS	PRE-SCHOOL	KDGN	1ST	2ND	3RD	4TH	5TH	6TH	7TH	8TH	9TH	10TH	11TH	12TH	Enrollment Total	Inc. P/S Enrollment Total
		Aurora Borealis Charter	1	0	0	0	0	0	0	0	0	0	0	0	0	0	0	1
		Chapman	11	0	0	0	0	0	0	0	0	0	0	0	0	0	0	11
		Connections Program	0	0	0	0	0	0	0	0	0	0	0	0	0	1	1	1
		Cooper Landing	0	0	0	0	0	0	0	0	0	0	0	0	0	0	0	0
		Distance Education Program	0	0	0	0	0	0	0	0	0	0	2	1	0	0	3	3
		District Wide Program	19	0	0	0	0	0	0	0	0	0	0	0	0	0	0	19
		Fireweed Academy	0	0	0	0	0	0	0	0	0	0	0	0	0	0	0	0
		Homer Flex	0	0	0	0	0	0	0	0	0	0	0	0	0	0	0	0
		Homer High	0	0	0	0	0	0	0	0	0	0	5	6	11	2	24	24
		Homer Middle	0	0	0	0	0	0	0	0	1	4	0	0	0	0	5	5
		Hope Elementary/High	0	0	0	0	0	0	0	0	0	0	0	0	0	0	0	0
		K-Beach Elementary	8	0	0	1	0	0	0	0	0	0	0	0	0	0	1	9
		Kachemak Selo	0	0	0	0	0	0	0	0	0	0	0	0	0	2	2	2
		Kaleidoscope Charter	0	0	0	0	0	0	0	0	0	0	0	0	0	0	0	0
		Kenai Alternative	13	0	0	0	0	0	0	0	0	0	0	1	0	3	4	17
		Kenai Central High	0	0	0	0	0	0	0	0	0	1	7	10	19	5	42	42
		Kenai Middle	0	0	0	0	0	0	0	2	1	0	0	0	0	0	3	3
		Marathon	0	0	0	0	0	0	0	0	0	0	0	0	0	0	0	0
		McNeil Canyon Elementary	0	0	0	0	0	0	0	0	0	0	0	0	0	0	0	0
		Moose Pass Elementary	0	0	0	0	0	0	0	0	0	0	0	0	0	0	0	0
		Mountain View Elementary	25	1	1	0	0	0	0	0	0	0	0	0	0	0	2	27
		Nanwalek Elementary/High	0	0	0	0	0	0	0	0	0	1	0	0	0	0	1	1
		Nikiski Middle/High	0	0	0	0	0	0	0	1	0	1	1	1	0	0	4	4
		Nikiski North Star Elementary	23	0	0	1	0	0	0	0	0	0	0	0	0	0	1	24
		Nikolaevsk Elem/High	1	0	0	0	0	0	0	0	0	0	0	0	0	0	0	1
		Ninilchik Elementary/High	0	1	1	0	1	0	0	0	0	0	0	1	1	1	6	6
		Paul Banks Elementary	32	1	3	0	0	0	0	0	0	0	0	0	0	0	4	36
		Port Graham	0	0	0	0	0	0	0	0	0	0	0	0	0	0	0	0
		Razdolna	0	0	0	0	0	0	0	0	0	0	0	0	1	0	1	1
		Redoubt Elementary	20	0	0	0	0	0	0	0	0	0	0	0	0	0	0	20
		River City Academy	0	0	0	0	0	0	0	0	0	0	2	0	0	0	2	2
		Seward Elementary	28	0	0	0	0	0	0	0	0	0	0	0	0	0	0	28
		Seward High	0	0	0	0	0	0	0	0	0	4	0	0	0	0	4	4
		Seward Middle	0	0	0	0	0	0	0	0	0	0	0	0	0	0	0	0
		Skyview Middle	0	0	0	0	0	0	0	17	2	2	0	0	0	0	21	21
		Soldotna Elementary	50	1	0	0	0	0	6	2	0	0	0	0	0	0	9	59
		Soldotna High	0	0	0	0	0	0	0	0	0	0	0	7	14	8	29	29
		Soldotna Montessori Charter	0	0	0	0	0	0	1	0	0	0	0	0	0	0	1	1
		Soldotna Prep	0	0	0	0	0	0	0	0	0	0	5	0	1	0	6	6
		Sterling Elementary	10	0	0	1	0	0	0	0	0	0	0	0	0	0	1	11
		Susan B. English	0	0	0	0	0	0	0	0	0	0	0	1	2	1	4	4
		Tebughna Elementary/High	0	0	0	0	0	0	0	0	0	0	0	0	0	0	0	0
		Tustumena Elementary	11	3	0	1	0	1	0	0	0	0	0	0	0	0	5	16
		Voznesenka	6	0	0	0	0	0	0	0	0	0	0	0	0	1	1	7
		West Homer Elementary	0	0	0	0	0	0	0	0	0	0	0	0	0	0	0	0
			258	7	5	4	1	1	7	22	4	13	22	28	49	24	187	445



## KENAI PENINSULA BOROUGH SCHOOL DISTRICT

148 North Binkley Street Soldotna, Alaska 99669-7520

Phone (907) 714-8888 Fax (907) 262-9132

[www.kpbsd.k12.ak.us](http://www.kpbsd.k12.ak.us)

### SCHOOL BOARD COMMUNICATION

**Title:** Exhibit Revisions

**Date:** May 4, 2015

**Item Number:**

**Administrator:** Dave Jones, Assistant Superintendent *Dave Jones*

**Attachments:** E 6145.22(1) ASAA Parent's Guide to Concussions in Sports .... Page 2

☐ **Action  
Needed**

☐ **For  
Discussion**

☒ **Information**

☐ **Other:** \_\_\_\_\_

### BACKGROUND INFORMATION

Per BB 9313: "Exhibit pages are intended to be easily updated. They are provided as information items to Board members but are not subject to approval."

For your information, the following exhibit change is in your information packet.

- E 6145.22(1) ASAA Parent's Guide to Concussions in Sports
  - ASAA updated 4/15

### ADMINISTRATIVE RECOMMENDATION

# ASAA Parent's Guide to Concussions in Sports (Revised 04/14)

## What is a concussion?

- A concussion is a brain injury which results in a temporary disruption of normal brain function. The injury occurs when the brain is violently rocked back and forth or twisted inside the skull as a result of a direct or indirect force. An athlete does not have to lose consciousness ("knocked-out") to suffer a concussion. In fact only 3-10% of concussions do produce loss of consciousness.

## Concussion Facts

- It is estimated that over 250,000 high school athletes across the United States suffer a concussion each year. (Data from NFHS Injury Surveillance System, 2010-2011). The CDC estimates 5.5 million sports concussions occur annually in the United States (CDC, 2011)
- Concussions occur most frequently in hockey and football, but girls' soccer, boys' soccer, and girls' basketball follow closely behind. All athletes are at risk.
- A concussion is a traumatic injury to the brain.
- Concussion symptoms may last from a few days to many months.
- Concussions can cause symptoms which interfere with school, work, and social life.
- An athlete should not return to sports when still having symptoms from a concussion as they are at risk for prolonging symptoms and at risk for sustaining additional, more serious, brain injury.
- A concussion may cause multiple symptoms. Many symptoms appear immediately after the injury, while others may develop over the next several days or weeks. The symptoms may be subtle and are often difficult to recognize.

## What are the signs and symptoms of a concussion?

### SIGNS OBSERVED BY PARENTS, FRIENDS, TEACHERS OR COACHES

Appears dazed or stunned

Is confused about what to do

Forgets plays

Is unsure of game, score, or opponent

Moves clumsily

Answers questions slowly

Loses consciousness

### SYMPTOMS REPORTED BY ATHLETE

Headache

Nausea

Balance problems or dizziness

Double or fuzzy vision

Sensitivity to light or noise

Feeling sluggish

Feeling foggy or groggy

Shows behavior or personality changes

Can't recall events prior to hit

Can't recall events after hit

Concentration or memory problems

Confusion

### **What should I do if I think my child has had a concussion?**

If an athlete is suspected of having a concussion, he or she must be immediately removed from play, be it a game or practice. Alaska Statute requires that (1) a student who is suspected of having sustained a concussion during a practice or game shall be immediately removed from the practice or game and (2) a student who has been removed from participation in a practice or game for a suspicion of a concussion may not return to participation in practice or game play until the student has been evaluated and cleared for participation in writing by an athletic trainer or other qualified person who has received training, as verified in writing or electronically by the qualified person, in the evaluation and management of concussions.

Continuing to participate in physical activity after a concussion can lead to worsening concussion symptoms, increased risk for further injury, and even death. Parents, coaches, and officials are not expected to be able to "diagnose" a concussion, as that is the job of a medical professional. However, you must be aware of the signs and symptoms of a concussion. And, if you suspect a concussion, then your child must stop playing:

### **When in doubt, sit them out!**

All athletes who sustain a concussion need to be evaluated by a health care professional who is familiar with sports concussions. You should call your child's physician and explain what has happened and follow your physician's instructions. If your child is vomiting, has a severe headache, is having difficulty staying awake or answering simple questions he or she should be taken to the emergency department.

### **When can an athlete return to play following a concussion?**

After it is determined that an athlete has suffered a concussion, the athlete may not return to play or participate until the athlete has completed the ASAA Return to Play Protocol. Previously, athletes were allowed to return to play if their symptoms resolved within 15 minutes of the injury. Studies have shown us that the young brain does not recover quickly enough for an athlete to return to activity safely in such a short time.

Concerns over athletes returning to play too quickly have led state lawmakers, in Alaska and most other states, to pass laws stating **that no player shall return to play following a suspicion of concussion on that same day and the athlete**

**must be cleared by an appropriate health care professional before they are allowed to return to play in practices or games.** The laws also mandate that coaches receive education on recognizing the signs and symptoms of concussion.

Where an athlete is evaluated as having suffered a concussion, only when an athlete has been completely free of concussion symptoms for 24 hours, are they eligible to be cleared to begin the Return to Play Protocol. The athlete should proceed with activity in a step-wise fashion to allow the brain to re-adjust to exertion. There is a minimum of 24 hours between steps in the Protocol. Some athletes complete one step each day. An individual athlete may be guided through the Protocol more slowly if they are at risk for prolonged concussion or additional brain injury. If symptoms recur during exercise, then exercise is ended and begins the next day at the preceding day's level.

## **Concussion Return to Play Protocol (ASAA, 2/18/2012)**

- **Symptomatic Stage:**
  - Physical and Cognitive Rest.
  - Then Incremental Cognitive Work, without Provoking Symptoms.
  - **If no symptoms, then:**
- **Day 1:**
  - Begin when symptom free for 24 hours.
  - 15 min **light aerobic** activity (walk, swim, stationary bike, no resistance training).
  - **If no symptoms, then:**
- **Day 2:**
  - 30 min **light-mod aerobic** activity (jog, more intense walk, swim, stationary bike, no resistance training).
  - **Start PE Class** at previous day's activity level.
  - As RTP Protocol activity level increases, PE activity level remains one day behind.
  - **If no symptoms, then:**
- **Day 3:**

- 30 min **mod-heavy aerobic** activity (run, swim, cycle, skate, Nordic ski, no resistance training).
- **If no symptoms, then:**
- **Day 4:**
  - 30 min **heavy aerobic** (hard run, swim, cycle, skate, Nordic ski).
  - 15 min **Resistance Training** (push-up, sit-up, weightlifting)
  - **If no symptoms, then:**
- **Day 5:**
  - **Return to Practice, Non-contact Limited Participation** (Routine sport-specific drills).
  - **If no symptoms, then:**
- **Day 6:**
  - **Return to Full-Contact Practice**
  - **If no symptoms, then:**
- **Day 7:**
  - **Medically Eligible for Competition when completes RTP Protocol and is cleared by Healthcare Professional**
  - **ASAA Eligibility Criteria** must be met before return to competition.

**If symptoms recur at any step, the athlete should cease activity and be re-evaluated by their health care provider.**

### **How can a concussion affect schoolwork?**

Following a concussion, many athletes have difficulty with cognitive work: thinking, focusing attention, calculating, attending school, doing homework, taking tests. These problems may last from days to months and often involve difficulties with short and long-term memory, concentration, and organization.

Following concussion, athletes should begin with a period of rest, in which they avoid cognitive work. As concussion symptoms diminish and the athlete feels able, he/she can begin trials of cognitive work, e.g. reading, texting, computer, TV, videos, school. The introduction of cognitive work should be in short increments which increase progressively in length, so long as symptoms do not recur or worsen with the work. For example, start with 30 minutes of computer time, and, if symptoms do not worsen, try one hour later in the day. If several

hours of cognitive work are well tolerated at home, try attending a half day of school. When a full day of school is tolerated add homework.

Academic accommodations may be necessary for students attempting to attend school when they still have concussion symptoms. In many cases it is best to lessen the athlete's class load early on after the injury. This may include staying home from school for a few days, followed by a lightened schedule for a few days, or perhaps a longer period of time, if needed. Decreasing the stress on the brain early on after a concussion may lessen symptoms and shorten the recovery time. If cognitive work at any time provokes or exacerbates symptoms, then the work should be discontinued and there should be cognitive rest until the symptoms subside. The student can attempt to advance cognitive work again on the day following resolution of the increased symptoms.

### **What can I do?**

- Learn to recognize the "Signs and Symptoms" of concussion as listed above.
- Emphasize to administrators, coaches, and other parents your concerns and expectations about concussion and safe play.
- Teach your athlete to tell the coaching staff if the athlete suspects that they or a teammate has a concussion.
- Monitor sports equipment for safety, fit, and maintenance.
- Ask teachers to monitor any decrease in grades or changes in behavior that could indicate concussion.
- Report concussions that occurred during the school year or over the summer to appropriate school staff. This will help in monitoring and protecting injured athletes as they move to the next season's sports.

### **Why is it so important that an athlete not return to play until they have completely recovered from a concussion?**

Athletes who are not fully recovered from an initial concussion are significantly vulnerable for recurrent, cumulative, and even catastrophic consequences of a second concussive injury. The risk of such difficulties is diminished if the athlete is allowed time to recover from the concussion and return to play decisions are carefully made. No athlete should return-to-sport or other physical activity when symptoms of concussion are present.

### **Is a "CAT scan" or MRI needed to diagnose a concussion?**

Diagnostic imaging tests, which include CT ("CAT") and MRI scans, are rarely needed following a concussion. While these are helpful in identifying life-threatening brain injuries (e.g. skull fracture, bleeding, swelling), the tests are typically normal, even in athletes who have sustained a severe concussion. A

concussion is diagnosed based upon the athlete's story of the injury and a physical examination.

### **What is the best treatment to help my child recover more quickly from a concussion?**

The best treatment for a concussion is rest. There are no medications that can speed the recovery from a concussion. Exposure to loud noises, bright lights, computers, video games, television and phones (including text messaging) all may worsen the symptoms of a concussion. You should allow your child to rest as much as possible in the days following a concussion. As the symptoms lessen, you can allow increased access to computers, video games, etc., but the access must be lessened if symptoms worsen.

### **How long do the symptoms of a concussion usually last?**

The symptoms of a concussion will usually go away within two weeks of the initial injury. However, in some cases, symptoms may last for several weeks, or even months. Symptoms such as headache, memory problems, poor concentration, and mood changes can interfere with school, work, and social interactions. The potential for such long-term symptoms and disability underscores the need for careful management of all concussions.

### **How many concussions can an athlete have before he or she should stop playing sports?**

There is no "magic number" of concussions that determine when an athlete should give up playing contact or collision sports. The circumstances surrounding each individual injury, such as mechanism of injury and length of symptoms following the concussion, are very important and must be considered when assessing an athlete's risk for further and potentially more serious concussions. The decision to "retire" from sports can only be reached following a thorough review of the athlete's concussion history, coupled with a thorough and frank discussion between you, your doctor, and your child.

### **I've read recently that concussions may cause long-term brain damage in professional athletes. Is this a risk for high school athletes who have had a concussion?**

The issue of "chronic encephalopathy" in some former NFL and NHL players has received much media attention. Very little is known about what may be causing dramatic abnormalities in their brains. These players had long professional careers after playing in high school and college. In most cases, they played more than 20 years and suffered multiple concussions in addition to thousands of other blows to their heads. Alcohol, steroid, and other drug use may also have contributed to the brain changes. The average high school athlete does not



accumulate nearly the number of potentially injurious blows to the brain as a professional player. But we know that the teenage brain is much more vulnerable to injury and to more severe injury than the older brain. And the fact that we know very little about the long-term effects of concussions in young athletes is further reason to very carefully manage each and every concussion.

### **What will happen when my child completes the Return To Play Protocol?**

When the Return to Play Protocol has been successfully completed, the athlete will be examined by the responsible healthcare provider. Additional tests may be appropriate. The provider will sign a medical clearance to resume competition. The Return To Play Protocol together with medical examination is the internationally recognized process by which concussed athletes are returned to athletic participation as safely as possible. Completing the Return to Play Protocol and medical examination does not mean that the brain has fully recovered from concussion or that there is not risk in returning to competition. But it is the safest way that physicians know at this time. Participation in athletics is accompanied by risk of injury, permanent disability, and death. Having recently sustained a concussion, an athlete is at increased risk for another head injury. Once the athlete is medically eligible to return to competition, the parent and athlete will be asked to sign consent, accepting the risk in returning to play.

Some of this information has been adapted from the CDC's "Heads Up: Concussion in High School Sports," from materials by the OSAA's Medical Aspects of Sports Committee and from materials prepared by the NFHS Sports Medicine Advisory Committee. Please go to [www.cdc.gov/ncipc/tbi/Coaches\\_Tool\\_Kit.htm](http://www.cdc.gov/ncipc/tbi/Coaches_Tool_Kit.htm) or [www.nfhs.org](http://www.nfhs.org) for more information.

If you have any further questions regarding the policies and procedures for managing concussions in Alaska student athletes or want to know how to find a concussion specialist in Alaska, please visit the Alaska School Activities Association website, [asaa.org](http://asaa.org), and your school district website.

ASAA SMAC rev 2 18 2012

Adopted 4/15

To: Mr. Joe Arness, President of KPBSD Board of Education

From: Margaret Gilman, Nikiski North Star principal

Date: April 7, 2015

Re: Participation in ASCD Annual Conference

Having just returned from the ASCD Annual Conference held in Houston, I wanted to take the opportunity to update you and the other members of the school board on this valuable opportunity. Resources are always limited and it's vital for you to have information as you make decisions so I wanted you to know firsthand about the benefits of attending such a conference.

I was able to take three members of my school's Leadership Team with me to the conference. We attended a three day pre-conference entitled, "Teaching Up! Equity and Education for All" and also attended the first day of the three day conference. It was so valuable to attend the conference as a team as it allowed us to immediately discuss, digest, and plan for using the ideas in our school.

"Teaching Up" focused on the concept of providing an equitable education for all students and a continued reminder that it is our responsibility to educate all students regardless of any barriers they may bring with them to school. A key point in the presentation was the concept that "equitable" and "equal" are not synonymous and in fact may and probably should look different for each learner. The analogy that best fits is everybody needs a shoe that is most suited to them rather than the same shoe for all. The shoe also needs to have room to grow so the idea is a mindset of continued growth for both student and teacher.

The keynote speaker was Sarah Bliss, a Harvard professor and author of the book "The Rise". Ms. Bliss was absolutely one of the most brilliant individuals I have ever had the opportunity to listen to. She has an undergraduate degree in art history and a doctorate in philosophy from Harvard. The premise of her speech was that trying and not finding success is not really a failure. In fact, that negative result is an opportunity to learn and it ties directly into the growth mindset. This has direct applicability to schools. We need to purposefully teach and model to our students that the true kernel of learning is in the trying and the analysis of your results rather than a feeling of defeat if "success" as we typically define it is not achieved.

Other sessions from the conference included information on the flipped classroom, teacher evaluation, how to specifically teach to the needs of boys, and scaffolding learning for students' needs. My leadership team and I would be very happy to share our experiences with other KPBSD schools that may be interested.

3/4/15 – 3/6/15

I attended the Professional Learning Communities (PLC) Summit Conference by Solution Tree in Phoenix with staff from Skyview Middle School, Soldotna High School, Nikiski middle/High School, and Homer High School. Not only were administrators present from the four schools, but teachers from three of the school also attended. This was a tremendous opportunity to further the PLC growth that is being implemented into the schools; specifically at Skyview Middle School and Soldotna High School. We were able to visit and chew on ideas that were presented which led to a very significant and beneficial experience.

A main component that I was looking for in attending was how was the administrator to function among the various PLC's that the school has. In the past I have been the keeper of the data and I would disaggregate it and then spew it out to the teachers with what I felt was the most relevant or in need of attention. How do I just give this to the teachers without feeling like I have lost something or put more on their plate which is full? I also was looking for information about the length of time and how the PLC's should be structured. I had read about these things, but to be able to see real world examples and have teachers there to see them to show that it works was insightful and had a good impact.

The commitment for the whole team is vital. I see that there has not been this commitment in the past and I was impressed with how the DuFour's discussed different strategies for the administrator to build a common vision for the PLC process. Critical questions to ask each team and they have to have the answers. The questions are part of building a results-orientated culture and I need to be able to lead them through so as to setting attainable goals.

In order for the teachers to use data, they have to have data to look at and it has to be an accurate reflection of the students' knowledge. This poses a problem when the teachers are not tightly coupled in their lessons. Common formative assessments are going to be necessary for the teachers to be able to reflect on lessons and student growth within their classes. PLC's will provide the avenue in which they will be able to do this.

The golden calf that seems to be at SOHI is the master schedule. There has not been time built into the day for the teachers to meet with their PLC groups. I am using what I have learned and the conversations I have had with other administrators within our own district and from the conference to make a new master schedule that will allow the PLC groups to have a meeting once a week. I feel that this will show the teachers that I am serious about this and am willing to make sacrifices to ensure that it is happening.

The hardest part of going to a conference of this type is the sheer volume of information that is hard. It is impossible to see every presenter and receive all of the information. I plan on continuing my learning of PLC and collaboration in order to be an effective leader for the staff for the years to come at Soldotna High School.



4/8/15



## **KENAI PENINSULA BOROUGH**

### **Legal Department**

144 North Binkley Street • Soldotna, Alaska 99669-7520

Toll-free within the Borough: 1-800-478-4441, Ext. 2120

**PHONE:** (907) 714-2120 • **FAX:** (907) 714-2379

[www.kpb.us](http://www.kpb.us)

**MIKE NAVARRE**  
**BOROUGH MAYOR**

## **MEMORANDUM**

**TO:** Assembly President  
President, Board of Education  
Members, Kenai Peninsula Borough Assembly  
Members, Kenai Peninsula Borough School District Board of Education

**THRU:** Mike Navarre, Borough Mayor

**FROM:** Colette Thompson, Borough Attorney 

**COPY:** Risk Management Committee

**DATE:** April 9, 2015

**SUBJECT:** Litigation Status Report

Following is a summary of the major lawsuits in which the borough and school district are involved. This list does not include the real property tax foreclosures and numerous standard tax collection cases pursued by the borough.

1. **Anderson v. Kenai Peninsula Borough School District and Todd Syverson.** Case No. 3KN-14-857 CI. Robert and Yvonne Anderson filed suit against the school district on October 2, 2014, claiming damages for the district's alleged failure to prevent purported harassment and bullying of their daughter by other students. The district and Mr. Syverson filed an answer denying their claims. Trial is being scheduled for the spring of 2016. Discovery is in process.
2. **King v. Kenai Peninsula Borough.** Case No. 3KN-14-310 CI. Latasha King filed suit against the borough on April 7, 2014, for damages allegedly sustained in a motor vehicle accident on a borough maintained road. The borough filed an answer and a crossclaim against the driver of the vehicle. As plaintiff settled with the driver the parties have agreed to dismiss the driver from the lawsuit. Investigation and discovery are continuing.

3. **Reekie v. KPBSD, et al.** Case no. 3HO-13-67 CI. Justin Reekie, Raymond Reekie and Shawn Leigh Reekie filed suit against the school district, the American Legion, Department of Alaska, Inc. and numerous other entities and individuals for damages allegedly sustained by Justin during baseball batting practice held at Homer High School on March 24, 2010. A mediation was held October 6, 2014, but no settlement was reached. Discovery is continuing and trial has been rescheduled to August 3, 2015.



PEGGE ERKENEFF  
Communications Specialist  
907.714.8888  
Fax 907.262.5857  
148 N. Binkley Street  
Soldotna, Alaska, 99669

e: [Pegge@KPBSD.org](mailto:Pegge@KPBSD.org)  
Facebook: [KPBSD](https://www.facebook.com/KPBSD)  
Twitter: [@KPBSD](https://twitter.com/KPBSD)  
[www.kpbsd.k12.ak.us](http://www.kpbsd.k12.ak.us)

**KENAI PENINSULA BOROUGH SCHOOL DISTRICT**

---

# INFORMATION

## *Alaska Measures of Progress (AMP) Assessment*

**Soldotna, April 2, 2015—The annual student assessment required by state law to meet federal requirements takes place for our students in grades 3 through 10 between March 30 and May 1, 2015. In 2015, the Alaska Measures of Progress (AMP) assessment replaced the Standards Based Assessment (SBA). With AMP, students will take two tests—English language arts and math—instead of three, with fewer questions overall.\***

**Several questions have been asked about the type of data and personal information that is collected in the AMP assessment—it is the same as has been collected by SBAs and other state assessments since 2005. To note:**

- “Basic student information and student test scores are collected. Basic student information includes the student’s name, Alaska student ID number, and specific demographic information. EED does not collect sensitive information such as physical addresses, mailing addresses, or Social Security numbers.”\*
- “No data about individual students is ever given to the federal government. No data is sold to companies.”\*
- “Individual student test data is provided to the student’s school district to inform instruction. Only authorized school district staff that have a legitimate educational interest (such as the student’s teacher or principal) may see a student’s data.”\*
- All data is protected by the [Family Educational Rights and Privacy Act \(FERPA\)](#), the federal law protecting the privacy of student education records, and that governs student data and what can be collected and reported.

**Please contact your school principal with any questions or concerns about the AMP assessment.**

\*LINKS from the Alaska Department of Education and Early Development

[EED: FAQs about Student Assessment Data](#)

[EED: For Parents: Why We Test](#)

[EED: 10 Benefits of New Assessment](#)

[EED: AMP Resources](#)

[EED: Requirement to Test Students on Statewide Assessments](#)

### **KPBSD: ONE DISTRICT, FORTY-FOUR DIVERSE SCHOOLS**

The mission of the Kenai Peninsula Borough School District is to develop productive, responsible citizens who are prepared to be successful in a dynamic world.

ANCHOR POINT COOPER LANDING HOMER HOPE KACHEMAK SELO KENAI MOOSE PASS NANWALEK NIKISKI NIKOLAEVSK NINILCHIK PORT GRAHAM  
RAZDOLNA SELDOVIA SEWARD SOLDOTNA STERLING TUSTUMENA TYONEK VOZNESENKA

**FOR RELEASE APRIL 2, 2015**

**###**

**1 OF 1**



PEGGE ERKENEFF  
Communications Specialist  
907.714.8888  
Fax 907.262.5857  
148 N. Binkley Street  
Soldotna, Alaska, 99669

e: [Pegge@KPBSD.org](mailto:Pegge@KPBSD.org)  
Facebook: [KPBSD](https://www.facebook.com/KPBSD)  
Twitter: [@KPBSD](https://twitter.com/KPBSD)  
[www.kpbsd.k12.ak.us](http://www.kpbsd.k12.ak.us)

**KENAI PENINSULA BOROUGH SCHOOL DISTRICT**

---

# NEWS RELEASE

## *Collective Bargaining Update*

**Soldotna, April 16, 2015—The Kenai Peninsula Borough School District (KPBSD) began Collective Bargaining negotiations with the Kenai Peninsula Education Association (KPEA), and the Kenai Peninsula Education Support Association (KPESA) in February 2015, and met four times before impasse was declared on April 15, 2015. The next step is mediation. The Federal Mediation and Conciliation Service (FMCS) has been contacted and will appoint a mediator. KPBSD is hopeful that the mediator can offer assistance to craft a mutually agreed upon negotiated contract.**

The District believes that given the state's fiscal process and current reality, we are far apart from KPEA and KPESA negotiators in our thinking and methodology, thus it is time to work through a mediator who will come to an analysis within the current reality we face. Our budget is based on revenues without certainty from the Governor or legislature about education funding. The District does not believe that our current offer to KPEA and KPESA would result in the elimination of staff positions or reduce services to our students.

### **KPBSD offer to KPEA and KPESA**

A one year contract, accounted for in the FY16 budget was passed by the Board of Education on April 6, 2015. The offer includes:

- Annual movement on the salary schedule for all eligible employees
  - Certified employees (teachers) receive 1.78% - 4.82%. Average increase is 2.67%
  - Classified employees (support staff) receive 3.44% - 12.35%. Average increase (after initial step in year one) is 4.12%
- A \$500 signing bonus outside the salary schedule for all fulltime employees; a pro-rated signing bonus for part-time employees
- The addition of a high-deductible healthcare plan option added to the current traditional healthcare plan

KPBSD values its excellent employees, seeks to provide stability and certainty for staff, students, and families, and is committed to our offer of eligible movement on the salary schedule, a signing bonus outside of the salary schedule for all employees, and more options in our self-funded healthcare plan.

### **Links**

[KPBSD 2015 Collective Bargaining](#)—offers, timeline, etc.

[Public Involvement in School District Negotiations](#)—KPBSD webpage

News Release: January 14, 2015—[Public Involvement in School District Negotiations](#)

### **KPBSD: ONE DISTRICT, FORTY-FOUR DIVERSE SCHOOLS**

The mission of the Kenai Peninsula Borough School District is to develop productive, responsible citizens who are prepared to be successful in a dynamic world.

ANCHOR POINT COOPER LANDING HOMER HOPE KACHEMAK SELO KENAI MOOSE PASS NANWALEK NIKISKI NIKOLAEVSK NINILCHIK PORT GRAHAM  
RAZDOLNA SELDOVIA SEWARD SOLDOTNA STERLING TUSTUMENA TYONEK VOZNESENKA

**FOR RELEASE APRIL 16, 2015**

**###**

**1 OF 1**





PEGGE ERKENEFF  
Communications Specialist  
907.714.8888  
Fax 907.262.5857  
148 N. Binkley Street  
Soldotna, Alaska, 99669

e: [Pegge@KPBSD.org](mailto:Pegge@KPBSD.org)  
Facebook: [KPBSD](https://www.facebook.com/KPBSD)  
Twitter: [@KPBSD](https://twitter.com/KPBSD)  
[www.kpbsd.k12.ak.us](http://www.kpbsd.k12.ak.us)

## KENAI PENINSULA BOROUGH SCHOOL DISTRICT

# News Release

## KPBSD and Education Funding in HB72

**Soldotna, April 10, 2015—The Senate and House Conference Committee for [HB 72](#) Operating Budget formed. The [first meeting is Friday, April 10, 2015](#), at 4:00 PM.**

- KPBSD understands that difficult financial decisions have to be made. We have confidence in our legislators and Speaker of the House Chenault, who have demonstrated support and advocacy for public education on the Kenai Peninsula.
- Over 80 percent of our 2015-2016 budget is related to staff (salary and benefits). The proposed reductions of \$8 million translates into the potential loss of up to 100 positions and vital programs.
- It is a constitutional responsibility of the State of Alaska to provide and maintain a public school system open to every child.

**Principal Nate Crabtree, K-Beach Elementary:** “Legislators are proposing additional reductions to education funding. Our children have one chance for a K-12 education and it needs to be the best we can provide. KPBSD is committed to delivering a quality education to our students and providing stability for our staff and communities. Unanticipated education funding reductions, proposed this late in the budgeting process, will have an impact on K-Beach Elementary. While it is imperative that we find ways to save money as a state, we need to carefully consider doing so in a way that doesn’t negatively influence students during these very formative years when the emerging skills of reading, writing, and math are taking root. Please consider ways in which you can positively influence legislators. Time is essential; the legislative session ends April 19, 2015.”

**Principal Dan Carstens, Nikiski Middle-High School:** “When I learned of the possible additional reduction to the BSA [Foundation Formula 4.1% reduction], I was taken aback and immediately examined my current staffing sheet to determine what else could go. It came down to programs and opportunities for our students. ... I looked at our Career and Technical Education (CTE) programs and would have to have lighter versions due to the fact that our instructors would need to teach a wider variety at mainly a beginning level. In other words, not a deep understanding, only introductory. Which would be a shame, especially with the variety of equipment we currently possess.”

**Soldotna High School student council:** “We, the students of Soldotna High School Student Council would like to address the current status of HB72 as it stands on April 8, 2015. We are gravely concerned about the educational implications of this bill if it should pass as it currently exists. ... We would encourage you to continue to look at a variety of ways to help balance the budget without such extreme cuts to education.”\*

**Please contact legislators to voice your opinion about the proposed reductions to education funding.**

### KPBSD: ONE DISTRICT, FORTY-FOUR DIVERSE SCHOOLS

The mission of the Kenai Peninsula Borough School District is to develop productive, responsible citizens who are prepared to be successful in a dynamic world.

ANCHOR POINT COOPER LANDING HOMER HOPE KACHEMAK SELO KENAI MOOSE PASS NANWALEK NIKISKI NIKOLAEVSK NINILCHIK PORT GRAHAM  
RAZDOLNA SELDOVIA SEWARD SOLDOTNA STERLING TUSTUMENA TYONEK VOZNESENKA

**FOR RELEASE APRIL 10, 2015**

**1 OF 2**



- ✓ **The Senate Finance Committee amended [HB 72](#) with a 4.1 percent reduction to the *Foundation Formula* educational funding on April 2, 2015. The impact to KPBSD is:**
  - Reduction of state contribution to KPBSD: \$4,238,432
  - Reduction of local (borough) contribution to KPBSD: \$977,007
- ✓ **Governor Walker proposed an operating budget reduction of educational *One-Time Funding* in [HB 72](#). The impact to KPBSD is:**
  - Reduction of state contribution to KPBSD: \$2,262,989
  - Reduction of local (borough) contribution to KPBSD: \$520,487

## **Potential 2015-2016 revenue loss to KPBSD: \$7,998,915**

**Total possible reduction in state funding to KPBSD: \$6,501,421**

**Total possible reduction in local (borough) funding to KPBSD: \$1,497,494**

Email the entire Legislature: <http://www.legis.state.ak.us/poms/>

Individual Senator Contacts: <http://akleg.gov/senate.php>

Individual Representative Contacts: <http://akleg.gov/house.php>

### **\*HB72 Operating Budget Conference Committee Members**

[Representative Mark Neuman](#) - [Representative.Mark.Neuman@akleg.gov](mailto:Representative.Mark.Neuman@akleg.gov) - 800-505-2678

[Representative Les Gara](#) - [Representative.Les.Gara@akleg.gov](mailto:Representative.Les.Gara@akleg.gov) - 888-465-2647

[Representative Steve Thompson](#) - [Representative.Steve.Thompson@akleg.gov](mailto:Representative.Steve.Thompson@akleg.gov) - 877-465-3004

[Senator Pete Kelly](#) - [Senator.Pete.Kelly@akleg.gov](mailto:Senator.Pete.Kelly@akleg.gov) - 877-665-3709

[Senator Anna MacKinnon](#) - [Senator.Anna.MacKinnon@akleg.gov](mailto:Senator.Anna.MacKinnon@akleg.gov) - 800-861-5688

[Senator Donald Olson](#) - [Senator.Donny.Olson@akleg.gov](mailto:Senator.Donny.Olson@akleg.gov) - 800-597-3707

### **Kenai Peninsula Legislators**

- **Senator Peter Micciche**, [Senator.Peter.Micciche@akleg.gov](mailto:Senator.Peter.Micciche@akleg.gov) - 907-465-2828
- **Senator Gary Stevens**, [Senator.Gary.Stevens@akleg.gov](mailto:Senator.Gary.Stevens@akleg.gov) - 907-465-4925
- **Representative Mike Chenault**, [Representative.Mike.Chenault@akleg.gov](mailto:Representative.Mike.Chenault@akleg.gov) - 907-465-3779
- **Representative Kurt Olson**, [Representative.Kurt.Olson@akleg.gov](mailto:Representative.Kurt.Olson@akleg.gov) - 907-465-2693
- **Representative Paul Seaton**, [Representative.Paul.Seaton@akleg.gov](mailto:Representative.Paul.Seaton@akleg.gov) - 907-465-2689
- **Representative Louise Stutes**, [Representative.Louise.Stutes@akleg.gov](mailto:Representative.Louise.Stutes@akleg.gov) - 907-465-2487

Connect with KPBSD on [Facebook](#), [twitter](#), our [Mobile App](#), and [website](#) to follow updates. Contacts for Alaska legislators are noted in this announcement, and also on the [Alaska State Legislature webpage](#).

### **Links**

[HB 72](#)

[KPBSD and the Legislature webpage](#)

[The Alaska State Legislature webpage](#)

Media Release [April 3, 2015: Proposed reduction to education funding in Alaska](#)

April 7, 2015: [Education Funding and KPBSD](#)

April 8, 2015: [HB 72 and Education Funding in KPBSD](#)

\*April 9, 2015: [Soldotna High School student council addresses education funding](#)

###

### **KPBSD: ONE DISTRICT, FORTY-FOUR DIVERSE SCHOOLS**

The mission of the Kenai Peninsula Borough School District is to develop productive, responsible citizens who are prepared to be successful in a dynamic world.

ANCHOR POINT COOPER LANDING HOMER HOPE KACHEMAK SELO KENAI MOOSE PASS NANWALEK NIKISKI NIKOLAEVSK NINILCHIK PORT GRAHAM  
RAZDOLNA SELDOVIA SEWARD SOLDOTNA STERLING TUSTUMENA TYONEK VOZNESENKA

**FOR RELEASE APRIL 10, 2015**

**2 OF 2**



PEGGE ERKENEFF  
Communications Specialist  
907.714.8888  
Fax 907.262.5857  
148 N. Binkley Street  
Soldotna, Alaska, 99669

e: [Pegge@KPBSD.org](mailto:Pegge@KPBSD.org)  
Facebook: [KPBSD](https://www.facebook.com/KPBSD)  
Twitter: [@KPBSD](https://twitter.com/KPBSD)  
[www.kpbsd.k12.ak.us](http://www.kpbsd.k12.ak.us)

**KENAI PENINSULA BOROUGH SCHOOL DISTRICT**

# NEWS RELEASE

## *Proposed reduction to education funding in Alaska*

**Soldotna, April 3, 2015—**The Senate Finance Committee has amended [HB 72](#), proposing a 4.1 percent reduction to the *Foundation Formula* educational funding. The reduction to the state contribution also impacts the maximum allowable contribution the Kenai Peninsula Borough (KPB) can contribute to the school district. KPBSD is analyzing the potential impact of this additional reduction in revenue to our 2015-2016 budget, together with our commitment to provide stability for our students, staff, and community within the changing fiscal climate. The impact of the unanticipated [HB 72](#) reductions to the KPBSD budget are:

Senate Finance Committee proposed education *Foundation Formula* reduction of 4.1 percent:

- Reduces state contribution to KPBSD: \$4,238,432
- Reduces local (borough) contribution to KPBSD: \$977,007

Governor Walker's proposed operating budget reduction of educational *One-Time Funding*:

- Reduces state contribution to KPBSD: \$2,262,989
- Reduces local (borough) contribution to KPBSD: \$520,487

### **Potential FY16 revenue loss: \$7,998,915**

Total possible reduction in state funding to KPBSD: \$6,501,421

Total possible reduction in local (borough) funding to KPBSD: \$1,497,494

"I'm very concerned that the legislature is proposing these further reductions to education funding, particularly this late in our process of budgeting and staffing for next year," said Superintendent Sean Dusek. "KPBSD is committed to deliver a quality education to our students, and provide stability for our staff and communities. These reductions compromise our ability to prepare our students for their future. We will discuss the budget and potential ramifications with the school board during a previously scheduled worksession on Monday, April 6, 2015."

Over 80 percent of the 2015-2016 budget is related to staff (salary and benefits). An \$8 million reduction translates into the potential loss of up to 100 positions.

### **KPBSD: ONE DISTRICT, FORTY-FOUR DIVERSE SCHOOLS**

The mission of the Kenai Peninsula Borough School District is to develop productive, responsible citizens who are prepared to be successful in a dynamic world.

ANCHOR POINT COOPER LANDING HOMER HOPE KACHEMAK SELO KENAI MOOSE PASS NANWALEK NIKISKI NIKOLAEVSK NINILCHIK PORT GRAHAM  
RAZDOLNA SELDOVIA SEWARD SOLDOTNA STERLING TUSTUMENA TYONEK VOZNESENKA

**FOR RELEASE APRIL 3, 2015**

**1 OF 2**

## **Links**

[HB 72](#)

[KPBSD and the Legislature webpage](#)

[The Alaska State Legislature webpage](#)

**###**

### **KPBSD: ONE DISTRICT, FORTY-FOUR DIVERSE SCHOOLS**

The mission of the Kenai Peninsula Borough School District is to develop productive, responsible citizens  
who are prepared to be successful in a dynamic world.

ANCHOR POINT COOPER LANDING HOMER HOPE KACHEMAK SELO KENAI MOOSE PASS NANWALEK NIKISKI NIKOLAEVSK NINILCHIK PORT GRAHAM  
RAZDOLNA SELDOVIA SEWARD SOLDOTNA STERLING TUSTUMENA TYONEK VOZNESENKA

**FOR RELEASE APRIL 3, 2015**

**2 OF 2**



PEGGE ERKENEFF  
Communications Specialist  
907.714.8888  
Fax 907.262.5857  
148 N. Binkley Street  
Soldotna, Alaska, 99669

e: [Pegge@KPBSD.org](mailto:Pegge@KPBSD.org)  
Facebook: [KPBSD](https://www.facebook.com/KPBSD)  
Twitter: [@KPBSD](https://twitter.com/KPBSD)  
[www.kpbsd.k12.ak.us](http://www.kpbsd.k12.ak.us)

**KENAI PENINSULA BOROUGH SCHOOL DISTRICT**

# NEWS RELEASE

## ***KPBSD launches new system to accept online payments***

**Soldotna, April 21, 2015—“Mom, I forgot my lunch money!” Have you ever wanted to add money to a school meal account, for a student activity fee, donation, or lost book via an online payment? Now you can! KPBSD is working with RevTrak, which allows parents and other interested parties to make online payments to the school district, via a computer or mobile device.**

### **Food service payments**

Online payment for food services is now available for all KPBSD schools. Online payments are processed in real time; this means that someone could make a payment in the morning, and the funds would be available for the student when he or she goes to lunch that day.

### **Student activity fees**

Kenai Central High School and Ninilchik School are piloting the receipt of online payments for student activities, such as class fees, activity participation fees, donations, lost book fees and so forth. Additional schools are going live in coming weeks.

### **To make a payment**

Parents or other people making payments or donations can access a student record in three ways to make payments:

- Use of the PowerSchool [parent portal](#)
- Through the KPBSD website *online payments* link on the [Students-Parents tab](#)
- Via the *online payments* icon on the [KPBSD mobile app](#)

“The district has had many requests for some type of online payment capability, so we are glad to be able to offer this service for students and we hope it will be helpful,” said Laurie Olson, director of finance. “Liz Hayes in our finance department together with Eric Soderquist and David Henson in information services have worked since last summer to get this online and functioning; they are the main reason we are able to offer this service.”

There is a 3.61% processing fee calculated on all payments, no exceptions. This is the actual cost of the processing fee from RevTrak, and is not a source of revenue for the district.

### **KPBSD: ONE DISTRICT, FORTY-FOUR DIVERSE SCHOOLS**

The mission of the Kenai Peninsula Borough School District is to develop productive, responsible citizens who are prepared to be successful in a dynamic world.

ANCHOR POINT COOPER LANDING HOMER HOPE KACHEMAK SELO KENAI MOOSE PASS NANWALEK NIKISKI NIKOLAEVSK NINILCHIK PORT GRAHAM  
RAZDOLNA SELDOVIA SEWARD SOLDOTNA STERLING TUSTUMENA TYONEK VOZNESENKA

**FOR RELEASE APRIL 21, 2015**

**###**

**1 OF 1**



PEGGE ERKENEFF  
Communications Specialist  
907.714.8888  
Fax 907.262.5857  
148 N. Binkley Street  
Soldotna, Alaska, 99669

e: [Pegge@KPBSD.org](mailto:Pegge@KPBSD.org)  
Facebook: [KPBSD](https://www.facebook.com/KPBSD)  
Twitter: [@KPBSD](https://twitter.com/KPBSD)  
[www.kpbsd.k12.ak.us](http://www.kpbsd.k12.ak.us)

**KENAI PENINSULA BOROUGH SCHOOL DISTRICT**

# NEWS RELEASE

## *Title VII and Federal Programs Advisory Committee Meeting*

**Soldotna, April 27, 2015—The Kenai Peninsula Borough School District will hold a combined meeting of the Title VII and Federal Programs Advisory Committees on Thursday, May 7, 2015, from 3:00 p.m. to 4:00 p.m. in the Borough Assembly Chambers, Soldotna, Alaska.**

The Committees are comprised of parents and guardians of district students who have been appointed by school site councils. Interested tribal elders, community members and parents are encouraged to attend and participate.

**Thursday, May 7, 2015**

**3:00-4:00 p.m.**

**Borough Assembly Chambers**

**Borough Administration Building**

**144 North Binkley Street, Soldotna, Alaska 99669**

Agenda:

- Program Reports and public input for Title IA, Title IC, McKinney-Vento, Title IIA, Title IIIA and Title VII
- Review testing data
- Set priorities for the 2015-2016 school year.

**Please RSVP** to Maribeth Snell, [MSnell@KPBSD.k12.ak.us](mailto:MSnell@KPBSD.k12.ak.us)

**Direct further questions to** Tim Vlasak, Director of Federal Programs and Assessments  
[TVlasak@KPBSD.k12.ak.us](mailto:TVlasak@KPBSD.k12.ak.us), 907.714.8829

###

### **KPBSD: ONE DISTRICT, FORTY-FOUR DIVERSE SCHOOLS**

The mission of the Kenai Peninsula Borough School District is to develop productive, responsible citizens who are prepared to be successful in a dynamic world.

ANCHOR POINT COOPER LANDING HOMER HOPE KACHEMAK SELO KENAI MOOSE PASS NANWALEK NIKISKI NIKOLAEVSK NINILCHIK PORT GRAHAM  
RAZDOLNA SELDOVIA SEWARD SOLDOTNA STERLING TUSTUMENA TYONEK VOZNESENKA

**FOR RELEASE APRIL 27, 2015**

###

**1 OF 1**



## KENAI PENINSULA BOROUGH SCHOOL DISTRICT

148 North Binkley Street Soldotna, Alaska 99669-7520

Phone (907) 714-8888 Fax (907) 262-9132

[www.kpbsd.k12.ak.us](http://www.kpbsd.k12.ak.us)

### SCHOOL BOARD COMMUNICATION

**Title:** Resignations

**Date:** May 4, 2015

**Item Number:**

**Administrator:** Joann Riener, Director, Human Resources  
Dave Jones, Assistant Superintendent

**Attachments:**

☐ Action Needed ☐ For Discussion ☒ Information ☐ Other: \_\_\_\_\_

### BACKGROUND INFORMATION

Name	Assignment	Location & Effective Date
Kevin Co	Non-Instructional Aide	Fireweed Academy, effective April 17, 2015
John Evans	Custodian I	Kenai Middle School, effective at the end of the 2014-15 school year
Puangthong Floyd	Food Service Cashier / Kitchen Assistant	Kenai Central High School, effective at the end of the 2014-15 school year
Raymond Ford	Special Education Intensive Needs Aide	West Homer Elementary School, effective March 24, 2015
Sandra Geagel	School Secretary III	Susan B. English School, effective at the end of the 2014-15 school year
Marion Glaser	Special Education Resource Aide	Moose Pass School, effective May 1, 2015
Daniel Hetrick	Custodian I	Nanwalek School, effective March 3, 2015
Scott Landfried	Custodian I	Kenai Central High School, effective April 25, 2015
Lara Ross	Instructional Tutor	Kenai Middle School, effective April 30, 2015
Brandon Smith	Custodian I	Homer High School, effective April 9, 2015